

PARTS & INSTALLATION INSTRUCTIONS MEYER SNOW PLOW LIGHTS

PARTS LIST

ITEM	PART NO.	QTY.	DESCRIPTION
	07033	1	SNOW PLOW LIGHT CARTON
1	07034	1	• Snow Plow Light, Pass. Side (No Hardware)
2	07978	1	•• Light Housing, Pass. Side
3	07976	1	•• Front Plate w/Amber Lens & Screws
4	07971	1	•• Halogen Sealed Beam Bulb
5	07062	1	•• Headlight Harness
6	07035	1	• Snow Plow Light, Driver's Side (No Hardware)
	07979	1	•• Light Housing, Driver's Side
3	07976	1	•• Front Plate w/Amber Lens & Screws
4	07971	1	•• Halogen Sealed Beam Bulb
5	07061	1	•• Headlight Harness
7	07036	1	• Vehicle Wirng Harness
	07037	1	• Parts Bag
8	07038	1	•• Toggle Switch w/Hardware
9	15658	1	•• Extension Handle, Blue
	07276	1	•• Flasher (Tung - Sol #552)
	07959	1	•• Rubber Grommet (Firewall)
10	07039	7	•• Tap Connector
11	07954	2	•• Adaptor Ferrule
12	20528	2	•• 1/2-13 Hex Nut
13	20329	2	•• 1/2 Lockwasher
14	_____	1	Tube of NYK77
15*	Not Included	1	R.H. Adaptor (Special)
16*	Not Included	1	L.H. Adaptor (Special)

Parts indented are included in the carton, bag or assembly under which they are indented.
Turn Signal Bulbs to be purchased locally.
* Special adaptor sets must be offered separately. Adpator sets will vary depending on vehicle model and year.

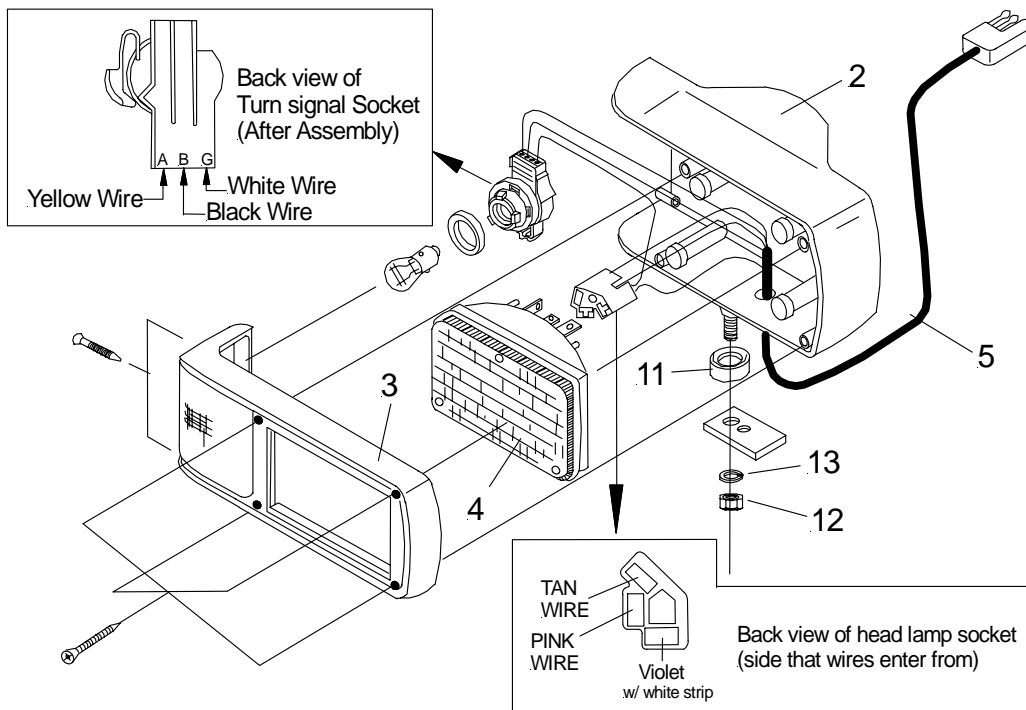

INSTALLATION INSTRUCTIONS

1. First identify vehicle headlamp type per Adapter Cross Reference Chart. Install the adapter sets (15 & 16) for the vehicle's headlamps. Specific instructions for each headlamp type are given in the special instructions section. The adapters are packaged separately.

Note: Imports- If vehicle headlamp type is not shown in the Cross Reference Chart, you must use the Meyer light kit 07969.

2. Mount the lights (1 & 6) to the light brackets using supplied hardware.

Note: After installation is complete, Snow Plow lights must be aimed to comply with Federal Motor Vehicle Safety Standard 108.

3. Route the wire harness (7) from the switch bracket on the dashboard to the front of the truck. If necessary, drill a hole in the firewall for the harness and protect it with the grommet. Locate the two plug branch of the harness in a convenient location for plugging in the lights (1 & 6). This is generally behind the grill and behind the radiator favoring the driver side of the vehicle.

If the vehicle has no holes in the radiator support structure, the light harness can be routed down each side of the radiator and then brought back up behind the grill. The harness branch with the yellow and black single wire leads should be located near the driver side vehicle headlamp system, and the branch with the white and yellow wire should be located near the vehicle passenger side headlamps. Use NYK-77 compound in all molded pin and socket connections.

CAUTION: It is important that the Meyer harness, all wires from the Meyer light switch,, and all other electrical wires be routed around hot or moving engine parts, and any sharp sheet metal. Protection must be provided to guard against wire damage at these points. All excess or loose wires must be neatly secured using wire ties.

4. Install light switch (8) in hole of light switch bracket (found in the hydraulic carton). Plug in wires from wire harness as shown in figure 1.

5. Attach the ground eyelet on the white wire to a good clean chassis ground.

6. Locate vehicle's marker light wire and right & left turn signal wires. Using the tap connectors (10) provided, connect these wires as shown in figure 2 & 3. Use NYK-77 compound in all molded pin and socket connections. Install the heavy duty flasher (provided).

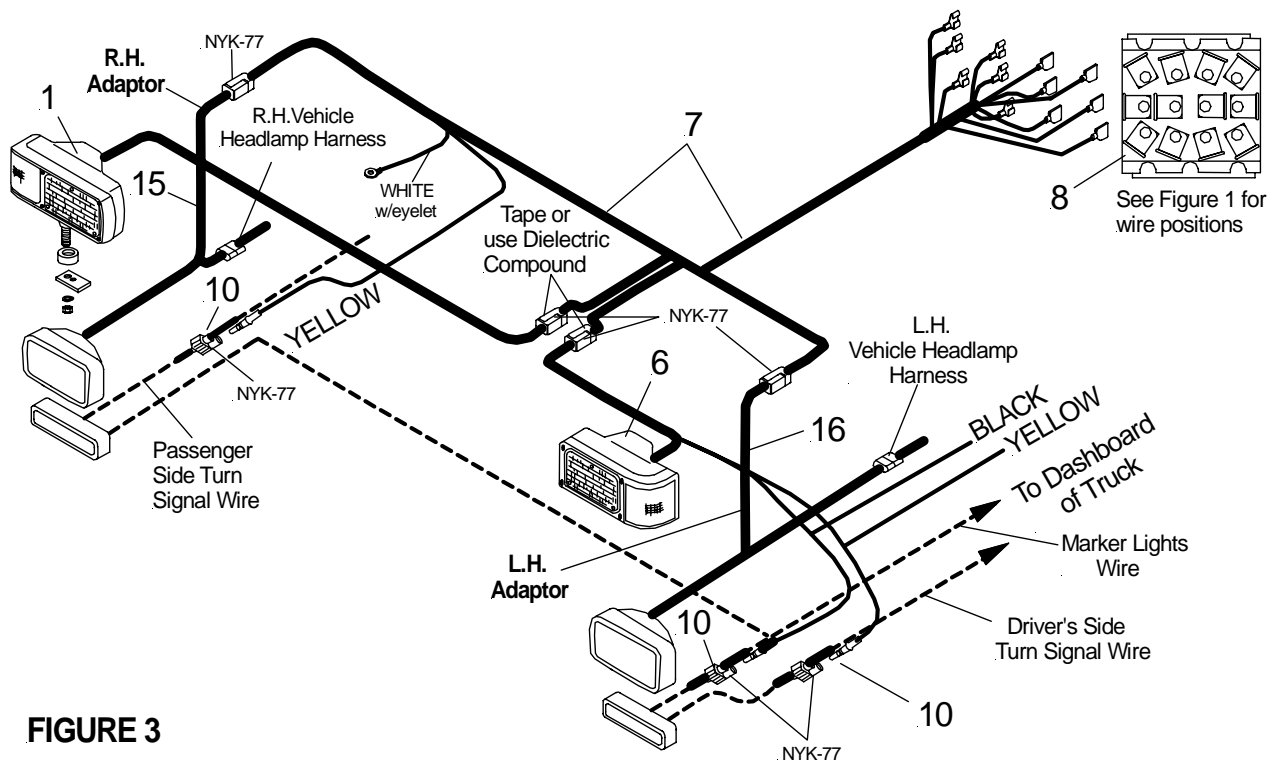

FIGURE 3

7. Verify that the installation is correct by turning on the vehicle headlamps, and switching from high to low beam on the vehicle set, then switch over to the plow lamp headlamp set, and check for high and low beam. At any one time, only the plow or vehicle lights should be on, never both sets at once. Verify DRL headlamp function by turning off the vehicle headlamp switch and turning on the ignition key, starting the engine if necessary. You should have DRL function on only one headlamp set (either plow or vehicle, never both). Switch over to the other set and check for proper function.

The installation is now complete.

SPECIAL INSTRUCTIONS:

For vehicles equipped with any of the following headlamps: Type 2D1 round, 178mm (7.0 in.) or type 2B1 large rectangular, 142mm x 200mm (5.6 in. x 7.9 in.).

Sealed beam trade numbers: **6014, 6015, H6024, H5024, 6052, H6054, HP6054, H5054** and **6053**. Bulb replaceable Halogen, single bulb per side. **HB2, H4** and **9003**.

This system will have a single sealed beam headlamp or a single bulb replaceable halogen bulb on each side of the vehicle. Use Meyer adapter set 07040. The Adapter with the white wire is used on the driver side of the vehicle and the adapter with the dark blue wire is used on the passenger side. Remove the vehicle headlamp harness from the vehicle headlamp. This will expose the three male blades that are part of the sealed beam. Install the adapter by pushing the hard-shell containing the blade receptacle terminals onto the three blades of the headlamp. The other end of the adapter will have a hard-shell containing male blades similar to the blades on the sealed beam. Plug the vehicle harness that was removed from the headlamp into this hard-shell. Some plastic may need to be removed from the connectors if the vehicle hard-shell does not fit into the adapter hard-shell containing the three male blades. The black molded plug with the Meyer name is then attached to the main harness. The procedure is the same for both sides of the vehicle, however, on the passenger side, the hard-shell containing the male blades will only have one blade in it.

For vehicles equipped with any of the following headlamps:

Type 2A1-1A1 rectangular, 100mm x 165mm (4.2 in. x 6.5in.) or Type 2C1-1C1 round, 146mm (5.75in.). Sealed beam trade numbers: **4651, H4651, HP4651, H5051, 4652, H4656, HP4656, H6052, H5006, H5506, 4000, 4040, 4001, H5001** and **H5501**.

For rectangular lamps:

This system will have two sealed beam lamps on each side of the vehicle. One of these sealed beam lamps will have three male blades, and the other will have only two. The three blade lamp has both a high beam and a low beam, the two blade lamp is a high beam only. Use Meyer adapter set 07041. The adapter with the white wire is used on the driver side of the vehicle and the adapter with the dark blue wire is used on the passenger side. Remove the vehicle harness from the sealed beam having three blades. Install the adapter by pushing the hard-shell containing three blade receptacle terminals onto this headlamp. Now remove the vehicle harness from the two bladed sealed beam. Install the two position hard-shell with blade receptacle terminals onto this sealed beam. The other end of the adapter will have a hard-shell containing male blades similar to the blades on the headlamp. Plug the vehicle harness that was removed from the three bladed sealed beam into this hard-shell. The vehicle harness from the two bladed headlamp is left unattached. The black molded plug with the Meyer name is then attached to the main harness. The procedure is the same for both sides of the vehicle, however, on the passenger side, the hard-shell containing the male blades will have only one blade in it.

For Vehicles equipped with the following headlamps:

Bulb replaceable halogen, single bulb per side.
Bulb trade number **9007** or **HB-5**.

This system will have only one headlamp on each side of the vehicle, and will have only one headlamp bulb on each side of the vehicle. The headlamp may be part of a composite unit having more than one bulb, but only one bulb per side is the headlamp bulb. Use Meyer adapter set 07042. The adapter with the white wire is used on the driver's side of the vehicle and the adapter with the dark blue wire is used on the passenger side. Remove the vehicle harness from the vehicle headlamp bulb. **CAUTION:** The hard-shell will have a locking device that fastens it to the bulb. Care should be used to ensure that the locking device is not damaged. Attach the blue hard-shell on the adapter to the headlamp bulb. It will lock onto the bulb fashion as the vehicle harness did. The other end of the adapter has a molded socket which is an imitation of the bulb's connector portion. The vehicle harness should lock onto this socket. The black molded plug with the Meyer name is then attached to the main harness. The procedure is the same for both sides of the vehicle.

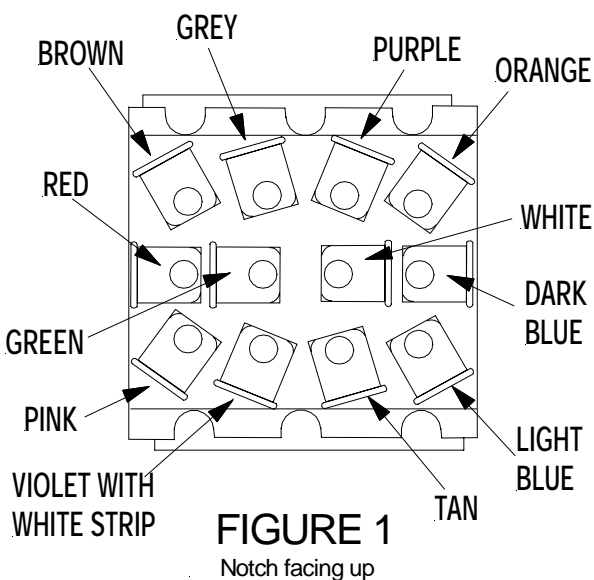

For vehicles equipped with the following headlamps:

Type LF-UF rectangular, 92mm x 150mm (3.6 in. x 5.9 in.). Sealed beam with trade numbers **H4701** and **H4703**.

This system will have two sealed beam headlamps on each side of the vehicle. Both sealed beams will have two small blade terminals, however one will have the two blades aligned and the other will have the two blades staggered. The lamp marked LF is the low beam and the lamp marked OF is the high beam. Use Meyer adapter set 07043. The adapter with the white wire is used on the driver side and the adapter with the dark blue wire is used on the passenger side. Remove the hard-shells from the sealed beam lamps and plug the adapter hard-shells onto the sealed beams. Following figure 5, push the blade terminals into the proper location on the vehicle harness hard-shells. There will be three wires to place on the driver side. The black molded plug with the Meyer name is the attached to the main harness. The procedure is the same for the passenger side, except that there is only one wire to place in the vehicle hard-shell. Figure 5 will identify which position and which hard-shell..

For vehicles equipped with the following headlamps:

Bulb replacement halogen, two bulbs per side.
Bulb trade number **9005** and **9006**, or **HB-3** and **HB-4**.

This system will usually have a composite headlamp on each side of the vehicle, with each headlamp having two headlamp bulbs. There may be others in the composite, but there will be only two headlamp bulbs per side. One bulb will be high beam and the other will be low beam. Use Meyer adapter set 07044. The adapter with the white wire is used on the driver side and the adapter with the dark blue wire is used on the passenger side. Remove the vehicle harness hard-shell plugs from each lamp and replace them with the hard-shell plugs on the adapter. They are keyed and cannot be assembled incorrectly. The hard-shells on the vehicle harness are then plugged into the female hard-shells on the adapter. These are also keyed and cannot be assembled incorrectly.

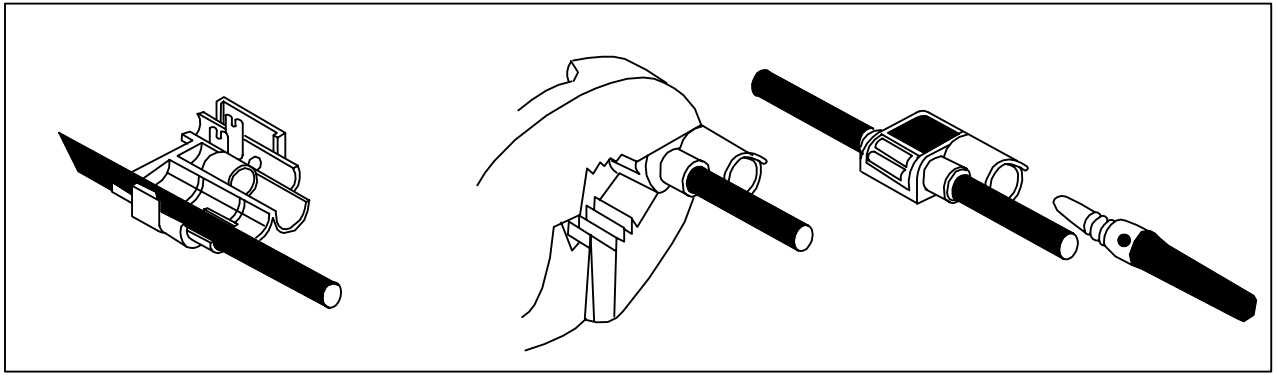

The black molded plug with the Meyer name is then attached to the main harness. The procedure is the same for the passenger side.

For vehicles equipped with the following headlamps:

Type 2E1 rectangular, 100mm x 165mm (9.42 in. x 6.5 in.). Sealed beam trade numbers **H4666**, **H6545** and **HP6545**.

This system will have one sealed beam headlamp on each side of the vehicle. Each headlamp will have three male blade terminals. Use Meyer adapter set 07045. The adapter with the white wire is used on the driver side of the vehicle and the adapter with the dark blue wire is used on the passenger side of the vehicle. Remove the vehicle harness from the headlamp. Install the adapter by attaching the hard-shell on the adapter to the headlamp. Plug the three blade terminals into the proper locations on the vehicle harness hard-shell as shown in figure 6. The black molded plug with the Meyer name is then attached to the main harness. The procedure is the same for the passenger side except that there is only one blade terminal to be inserted into the vehicle harness hard-shell.

IMPORTANT! For vehicles equipped with the following headlamps: Bulb trade number **9004** or **HB-1**.

The procedure is exactly the same as for the **9007** bulb, except use Meyer adapter set 07046 instead of 07042. These adapter sets look the same, but are not interchangeable. 07046 must be used only with **9004** bulbs, and 07042 must be used only with **9007** bulbs.

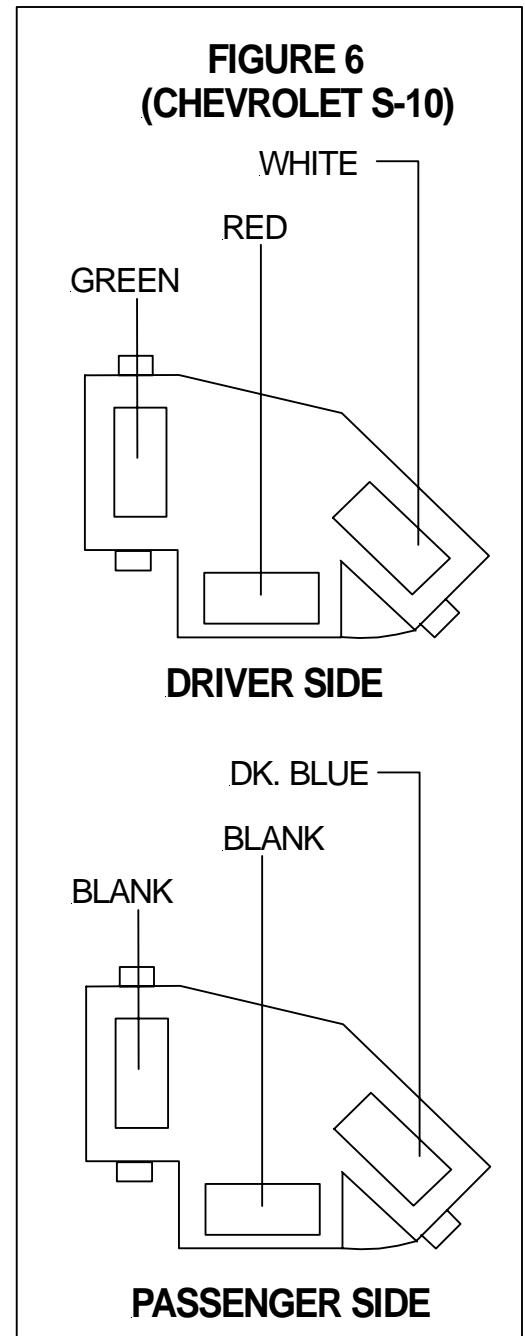

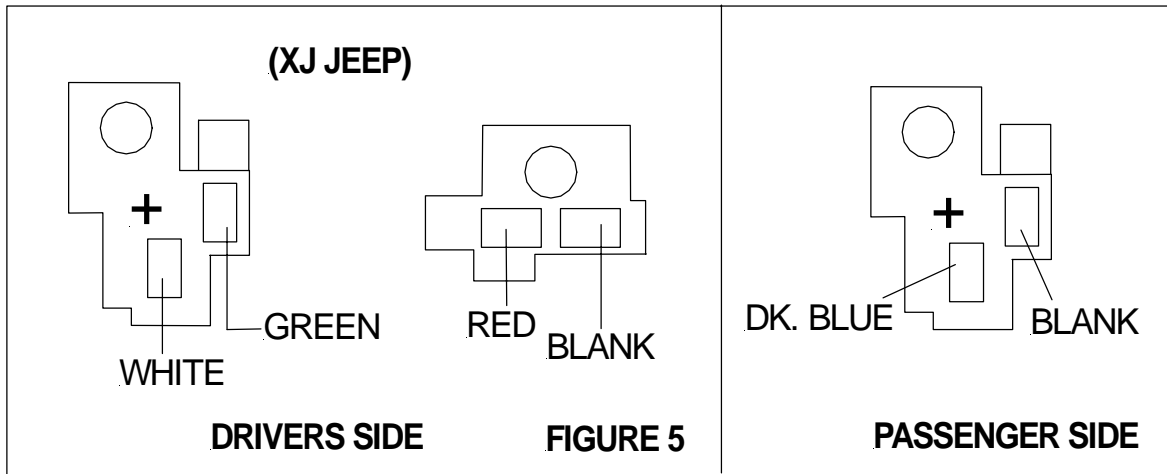

HEADLIGHT - ADAPTER CROSS REFERENCE

(IF VEHICLE HEADLAMP TYPE IS NOT SHOWN ON CHART BELOW,
MEYER LIGHT KIT 07969 MUST BE USED.)

HEADLAMP TYPE	HEADLAMP / BULB NUMBERS	ADAPTER NUMBERS
2D/2B HB2/H4	6014, H6024, H6014, 6052, H6054, HP6054, 9003	07040
1A/2A	4651, 4652, H4651, H4656, H4662	07041
HB5	H9007	07042
LF /UF	H4701, H4703	07043
HB3 / HB4	H9005, H9006	07044
2E	HP6545, H6545	07045
HB 1	H9004	07046