

EZ Build Assembly and Installation

41275 Lot Pro LD Plow 7'-6" with E-72 12V Hydraulic Unit



Meyer Products LLC reserves the right, under its continuing product improvement program, to change construction or design details, specifications and prices without notice or without incurring any obligation.

© 2012 Printed in the U.S.A.



Meyer Products LLC
18513 Euclid Ave. • Cleveland, Ohio 44112-1084
Phone 216-486-1313
www.meyerproducts.com • email info@meyerproducts.com

Table of Contents

General Information.....	1
Illustrated Parts Lists.....	2-4
Attaching Plow to EZ Build Assembly.....	5
Vehicle Side Wiring Diagram.....	6-7
Drop Speed Adjustment.....	7
Stop Bolt Adjustment.....	7
Mount Plow System To Vehicle.....	8
Dis-Mount Plow System From Vehicle.....	9
Pre-Delivery Inspection.....	10
Accessories.....	11

Web Based Support

Service Manuals



<http://www.meyerproducts.com/TechSupport/ServiceManualsandInstallationInstructions.aspx>

EZ-Troubleshooter



<http://www.meyerproducts.com/techsupport/EZtroubleshooter.aspx>

Owners Manual

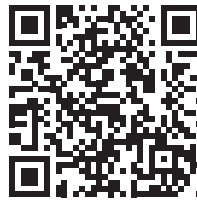

<http://www.meyerproducts.com/TechSupport/OwnersManuals.aspx>

Mount/Dismount Videos

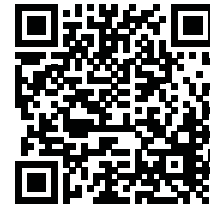

http://www.youtube.com/playlist?list=PLDE0602B305314D92&feature=edit_ok

Please visit our website to find our most updated technical information.

GENERAL INFORMATION

CAUTION Always disconnect battery prior to installation.

SAFETY PRECAUTIONS should be used when **Quik Lift®** is in a **RAISED** position. **LOWER** plow to the ground when vehicle is **PARKED**.

OVERHAUL and **SERVICE** information is covered on separate instructions.

WARNING Lift arm should be removed from vehicle if / when snowplow is removed.

Note:

1. Connect ground cable to negative side of battery for a solid connection to ground.
2. **CAUTION** Route all cables away from moving engine parts, Manifolds, and sharp sheet metal.
3. For weather protection, coat all connections with Meyer Dielectric Grease Part No. 15632
4. The vehicle must be equipped with a "Heavy Duty Battery" (70 Amp, Hr. Min.), 550 C.C.A. and "Alternator" (60 Amp. Min.) to obtain maximum performance.
5. Follow these instructions explicitly. Warranty does not apply to a Meyer product which has been negligently or improperly assembled or installed.

Tool list for Plow assembly:

Pliers	9/16" socket
1/2" socket	3/4" box wrench
1/2" box wrench	15/16" box wrench
9/16" box wrench	15/16" deep well socket

ADDITIONAL BATTERY CONNECTIONS

1. When attaching cables to battery with side post terminals, use M.P. Adaptor Part #21976.
2. Coat battery connections with battery terminal coating.

Please check the contents of your crate. Page 2 shows the assembled parts in the left hand column and the accessory box in the right hand column. Page 3 is the diagram for the left hand column of page 2.

TORQUE CHART FOOT POUNDS

Bolt Nut Size	Gr. 2	Gr. 5	Gr. 8
1/4 - 20	4 - 5		
5/16 - 18	9 - 11		
3/8 - 16	17 - 20	26 - 29	
7/16 - 14		42 - 46	60 - 66
1/2 - 13		64 - 72	90 - 100
5/8 - 11		127 - 141	179 - 198

Parts Diagram

41275 E-72 EZ Build

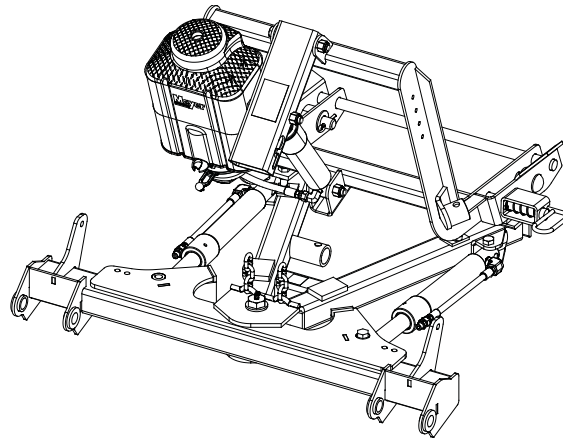

Parts List

Item	E-72 PKG Part No.	Qty.	Description	Item	E-72 PKG Part No.	Qty.	Description
	41275	1	DP 7'-6" E58H Plus Mount Assy.		41276	1	• Accessory Box
1	05815	1	Lift Ram 1.75 x 8"	34	05024	1	•• Power Cable - 36"
	07708	1	• L.H. Ram with Hose & Fittings	35	07178	2	•• Trip Spring
2	05877	1	•• Ram (1-1/2" x 10")		07550	1	•• Nite Saber II Kit
3	22866	1	•• SAE Mx3/8 90 Degree Elbow		08202	1	•• Plug Bracket Kit
4	22885	1	•• Hose 1/4 x 54"	36	19607	1	••• Plug Bracket
	07709	1	• R.H. Ram with Hose & Fittings	37	19609	1	••• Plate
2	05877	1	•• Ram (1-1/2" x 10")	38	20027	2	••• Bolt H 5/16-18 x 1 Gr. 2
3	22866	1	•• SAE Mx3/8 90 Degree Elbow	39	20326	4	••• Lockwasher 5/16
4	22884	1	•• Hose 1/4 x 33"	40	20525	4	••• Finish Nut 5/16-18
5	11859	2	• Blue Handle Pin	41	22658	2	••• Bolt H 5/16-18 x 3 Gr. 2
6	12590	1	• Pivot Bar Drive Pro		09917	1	•• Plow Marker Kit
7	13333	1	• E-72 Mounting Bracket	42	08214	2	••• Plow Marker
8	13940	1	• A-Frame Lot Pro Plus	43	20027	4	••• Bolt H 5/16-18 x 1 Gr. 2
8a	21541	2	• Chain 5/16 x 38" Gr. 43	44	20304	4	••• Locknut 5/16-18
8b	8518001026	2	• U-Bolt 7/16-14	45	20352	8	••• Flatwasher 5/16"
8c	20306	4	• Locknut 7/16-14	46	11751	1	•• Light Bracket LH
9	15645	1	• Lift Unit Cover	47	11752	1	•• Light Bracket RH
10	15634	1	• Cover Strap	48	11844	1	•• Receiver Tube Cap
11	16006	1	• Lift Assy. (Unit only)	49	15370	1	•• Starter Solenoid - 12 volt
12	19365	1	• Lift Frame		15787	1	•• Hardware Bag
13	19370	1	• Clevis	50	21398	2	••• S. Tap Screw 1/4 - 14 x 3/4"
14	19592	1	• Lift Arm	51	21832	1	••• Split Bushing
15	20029	4	• Bolt H 5/16-18 x 1-1/2" Gr. 2	52	-----	1	•• Optional Controller See Page 11
16	20049	2	• Bolt H 3/8-16 x 1" Gr. 2	53	22691	1	•• Universal Truck Side Harness
17	20146	1	• Bolt H 5/8 - 11 x 3-1/4" Gr. 5		41202	1	•• Hardware Bag
18	20147	4	• Bolt H 5/8 - 11 x 3-1/2" Gr. 5	54	09124	2	••• Eye Bolt
19	20152	1	• Bolt H 5/8 - 11 x 5" Gr. 5	55	20028	4	••• Bolt H 5/16-18 x 1-1/4 Gr. 2
20	20153	1	• Bolt H 5/8 - 11 x 5-1/2" Gr. 5	56	20326	4	••• Lockwasher 5/16"
21	20304	4	• Locknut 5/16-18	57	20406	2	••• Cotter Pin 3/16 x 1-1/2"
22	20309	7	• Locknut 5/8-11	58	20525	4	••• Finish Nut 5/16-18
23	20327	2	• Lockwasher 3/8"	59	22333	2	••• Pivot Pin w/grease fitting
24	20331	2	• Lockwasher 5/8"	60	814000005	2	• Spring
25	20406	3	• Cotter Pin 3/16 x 1-1/2"	61	8500003307001	2	• Bolt H 5/8-11 x 3 Full Thread
26	20420	2	• Cotter Pin 1/4 x 2"	62	8501003013	4	• 5/8-11 Jam Nut
27	22245	1	• Crank Stand				
28	22274	1	• Slotted Nut 1-8				
29	22398	1	• King Bolt 1-8 x 5-1/2"				
30	22436	2	• Pin 1 x 3"				
31	22692	1	• Plow Side Harness				
32	22866	1	• SAE Mx3/8 90 Degree Elbow				
33	22883	1	• Hose 1/4 x 22"				

Parts indented are included in the carton, bag or assembly under which they are indented.

Meyer Products LLC reserves the right, under its continuing product improvement program, to change construction or design details, specifications and prices without notice or without incurring any obligation.

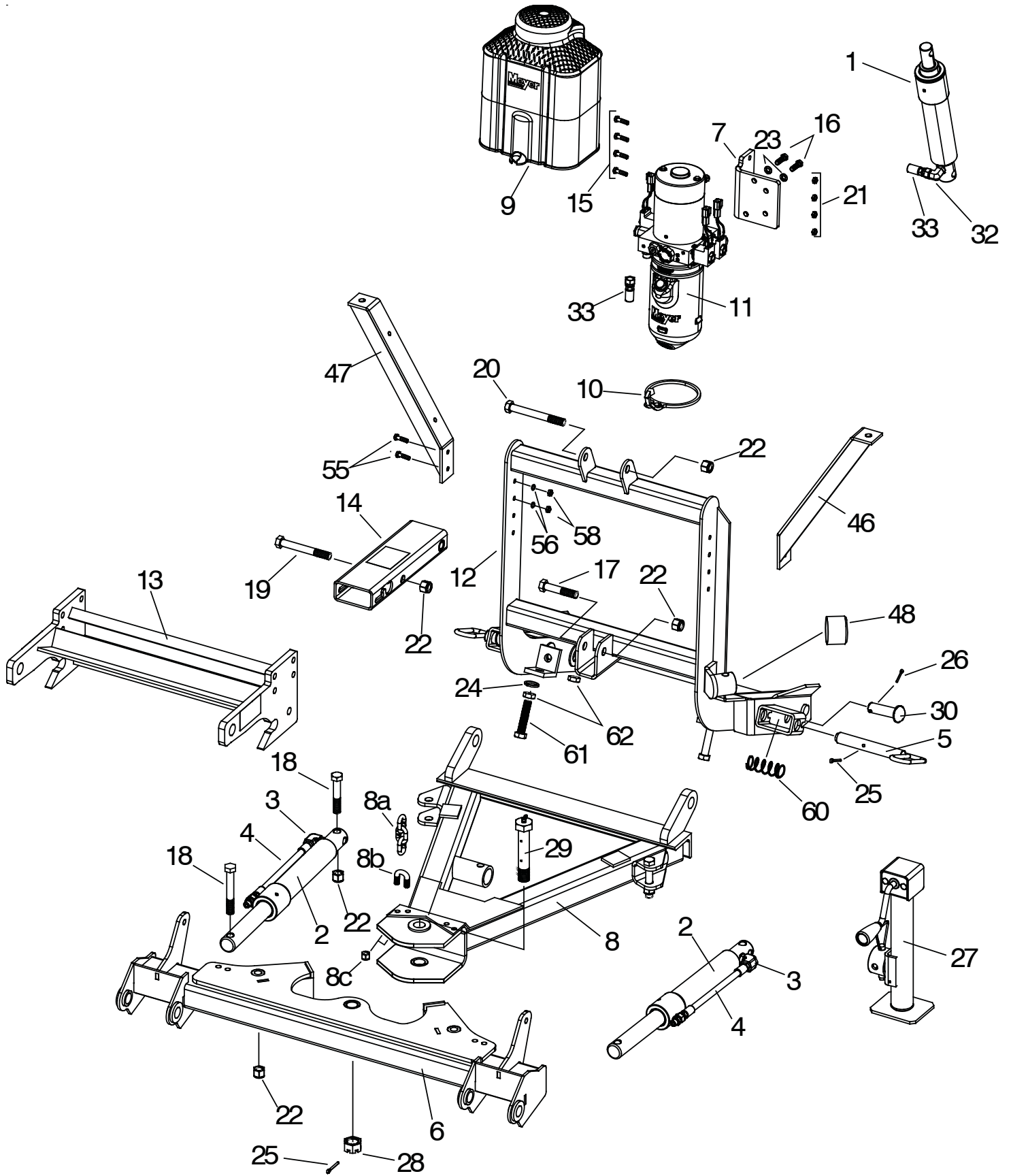

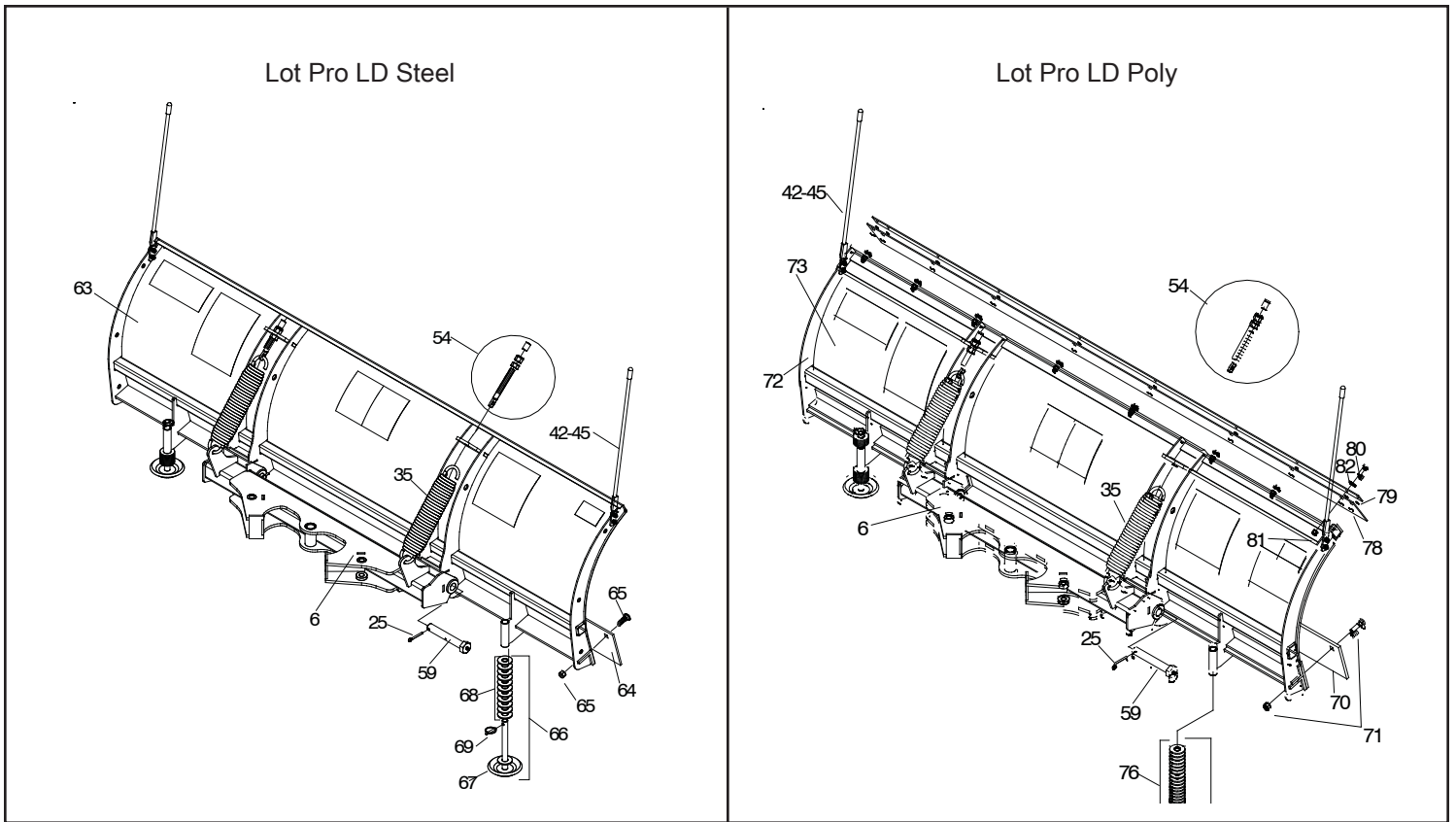

Drive Pro Steel Parts List

Item	LPLD - 7'6"	Qty	Description
63	09275	1	Moldboard Assembly
64	09796	1	• Cutting Edge 3/8" x 7'-6"
65	08184	1	• Bolt C 1/2-13 x 1-3/4 & Locknut (Kit of 9 each)
66	09127	2	• Mushroom Shoe Casting Assy.
67	10853	1	•• Runner Shoe Casting
68	20359	12	•• Flatwasher 3/4
69	22083	1	•• Linch Pin

Drive Pro Poly Parts List

Item	LPPLD - 7'6"	Qty	Description
	09278	1	Moldboard Assembly
70	09796	1	• Cutting Edge 3/8" x 7'-6"
71	08184	1	• Bolt C 1/2-13 x 2" & Locknut (Kit of 9 each)
72	12805	1	• Moldboard Frame Weldment
73	12856	1	• Plastic Sheet
74	09127	2	• Mushroom Shoe Casting Assy.
75	10853	1	•• Runner Shoe Casting
76	20359	20	•• Flatwasher 3/4
77	22083	1	•• Linch Pin
78	12471	1	• Deflector
79	12487	1	• Re-inforcement Bar
80	20050	8	• Bolt H 3/8-16 x 1-1/4
81	20305	8	• Locknut 3/8-16
82	20353	8	• Flatwasher 3/8

Parts indented are included in the assembly under which they are indented.

Meyer Products LLC reserves the right, under its continuing product improvement program, to change construction or design details, specifications and prices without notice or without incurring any obligation.

Attaching Plow to EZ Build Assembly

A. Attach L.H. and R.H. Light Brackets (46 & 47) to the side plates of Lift Frame (12) in the upper two holes using 5/16"-18 x 1-1/4" bolts (55), 5/16" lockwashers (56), and 5/16"-18 hex nuts (58). Note: Light brackets may be adjusted down two levels in height for better appearance on lower profile vehicles. Tighten all fasteners to their proper torque.

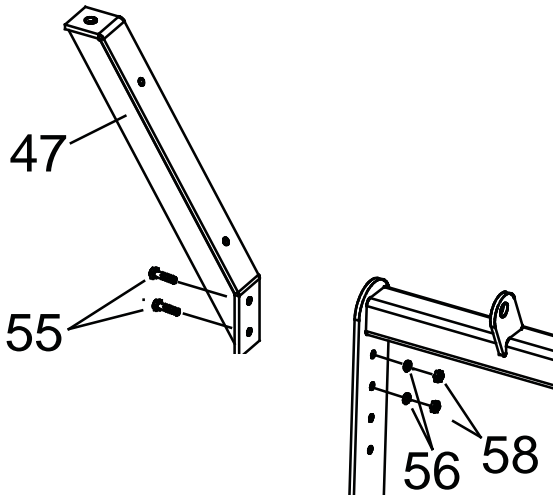

B. Liberally coat Pivot Pins (59) with Coolube Multi-Purpose Premium Grease Part No. 15181.

C. Attach Pivot Bar (6) to Moldboard with Pivot Pins (59) (grease fitting facing outward) and insert Cotter Pins (57). Grease Pivot Pin's (59) using grease fitting.

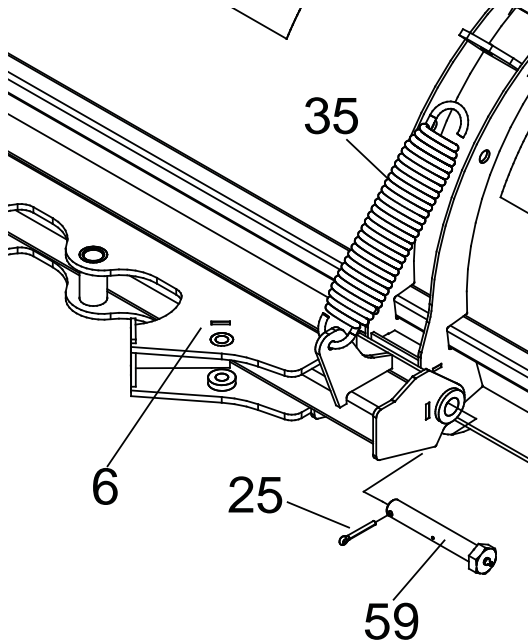

D. Attach Eye Bolts (54) to Moldboard and Trip Springs (35) to Pivot Bar (6), making certain locknuts are positioned as shown below.

E. Make certain each Eye Bolt (54) is in a vertical position as shown below so that the Eye Bolt (54) and Trip Spring (35) hinge properly when moldboard trips.

Note: Proper tension is attained when Trip Spring (35) coils just begin to separate and then tightening top locknut four additional turns. Tighten bottom Locknut (20530) to secure Eyebolt in position. Install Eyebolt caps (07031) over exposed threads.

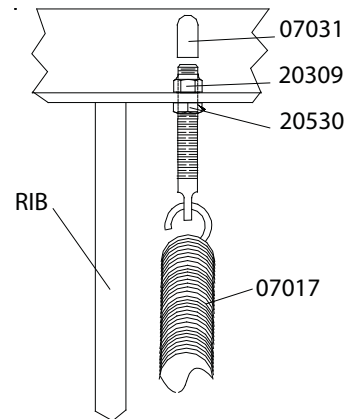

F. Attach Plow Markers (42) to moldboard using 5/16-18 x 1" Bolt (43), 5/16" Flatwasher (45) and 5/16-18 Locknut (44)

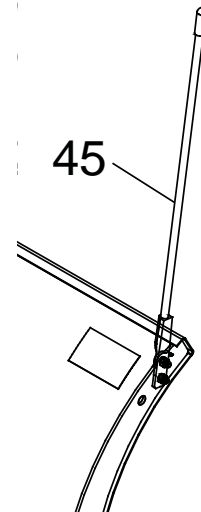

G. Attach the Lift Chain to the Lift Arm (14) through the two hooks on the lift arm. Adjust the lift chain at the lift arm so that there are 2-3 links of slack. This ensures that the plow blade will lift fully and be able to follow the ground contour while plowing.



Vehicle Side Wiring Diagram

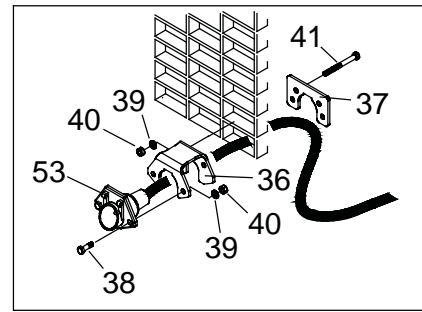
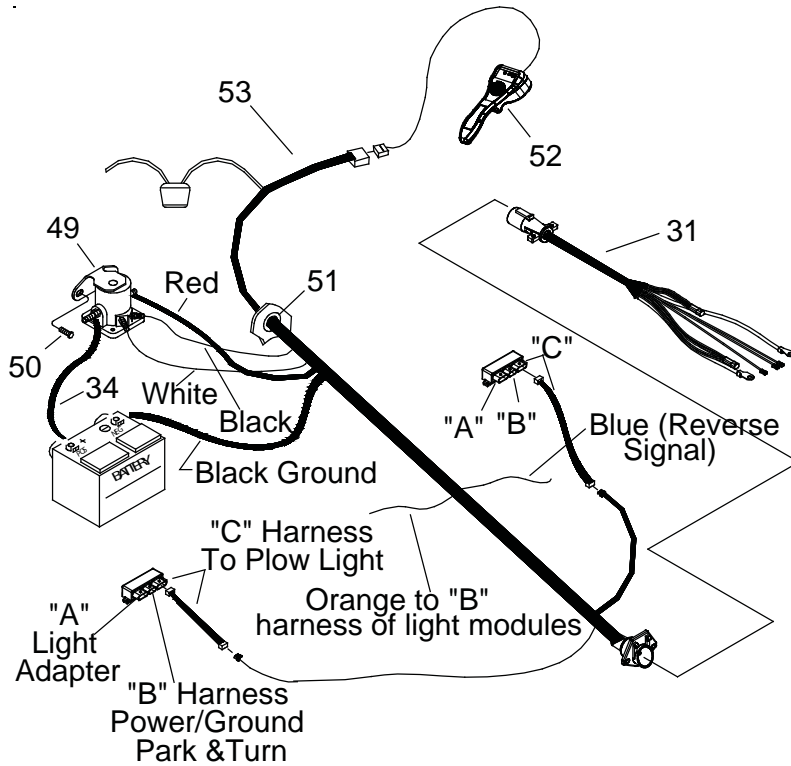

Hydraulic Solenoid Color Code:

OPERATION - SOLENOID COMBINATION

- RAISE** - Motor Solenoid + "B" Solenoid
- LOWER** - "A" Solenoid Only
- LEFT ANGLE** - Motor Solenoid Only
- RIGHT ANGLE** - Motor Solenoid + "C" Solenoid

COIL COLOR CODE

- MOTOR SOLENOID** - WHITE WIRE
- "A"** - BLACK WIRE
- "B"** - RED WIRE
- "C"** - GREEN WIRE
- GROUND WIRE EACH COIL** BLACK W/WHITE STRIPE

H. Run Universal Truck Side Harness (53) through a hole in grille and into the engine compartment. Sandwich vehicle grill between Plug Bracket (36) and Plate (37) using Bolt H 5/16-18 x 3" (41), 5/16 Lockwasher (39) and 5/16-18 Finish nut (40). Secure Universal Truck Side Harness (53) to Plug Bracket (36) using Bolt H 5/16-18 x 1" (38), 5/16 Lockwasher (39) and 5/16-18 Finish nut (40).

CAUTION Secure Universal Truck Side Harness (53) from any hot / moving parts with tie wraps as needed.

- I. Drill a 1-1/4" Diameter Hole thru firewall to install split bushing (51) and extend the harness into the cab of the vehicle. Fused lead from Universal Truck Side Harness (53) must be attached to terminal in fuse panel that is activated only when the ignition key is "on."
- J. Install Motor Solenoid (49) to metal surface in engine compartment using Self Tapping Screws (50). (Solenoid must be grounded to operate). Attach Red Power Cable (53) to a large terminal on Motor Solenoid (49). Attach Black Ground Cable (53) to negative (-) terminal of battery. Attach Red Power Cable (34) to positive (+) terminal of battery and remaining large terminal on Motor Solenoid (49). Attach small white wire from harness (53) to small terminal (S) on Motor Solenoid (49). Attach small Black/white stripe wire from harness (53) to small terminal (I)(ground) on Motor Solenoid (49). Attach Blue wire to a reverse signal on the vehicle. The blue wire is sensing when the vehicle is in reverse in order to operate HFP (Hands Free Plowing).

15059 Diode packed in Controller box

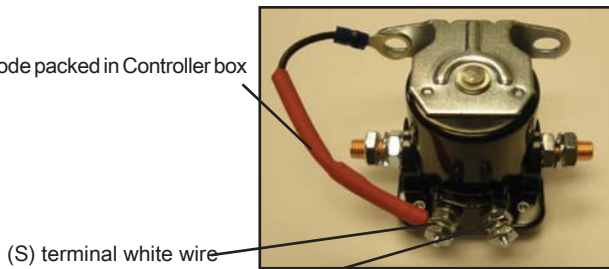

K. Add Meyer M-1 Hydraulic Fluid Part No. 15134 to reservoir and bleed the Angle Cylinders, proceed as follows:

- a. Remove Fill Plug from reservoir to add fluid during charging.
- b. Operate the Angle cylinders (1) until they are filled with Meyer M-1 Hydraulic Fluid and are not spongy.
- c. Top off the unit to the fill line on the reservoir with Meyer M-1 Hydraulic Fluid.

NOTE: Proper fluid level is to the fill line on the reservoir for the E-72. It must be checked with the lift cylinder fully retracted.

For snow plow light installation see separate instructions.

Orange wire on Harness (53) will attach to both orange wires of the "B" harness supplied in the Light Module Kit. Reference Form 1-757

Route Cables "C" (Yellow) from module to Harness (53). Connect both "C" Harness female ends to the male corresponding ends of the Harness (53).

Connect both male ends from the snow plow light to the female ends on the Plow Side Harness (31).

Check snow plow light blinkers to make sure the wires have not been reversed.

Note: All electrical connections should have both ends coated with a dielectric grease, Meyer Part No. 15632, prior to final installation. This will ensure a good connection and help in preventing corrosion.

L. Refer to Operation and Maintenance Manual for complete controller operation.

M. After all electrical connections have been made the drop speed of the plow may be evaluated / adjusted. To adjust, loosen the hex nut and adjust in to slow the drop speed and out to make it faster. After ideal drop speed is achieved, retighten the hex nut. See below.

After cycling of the plow, recheck oil level.

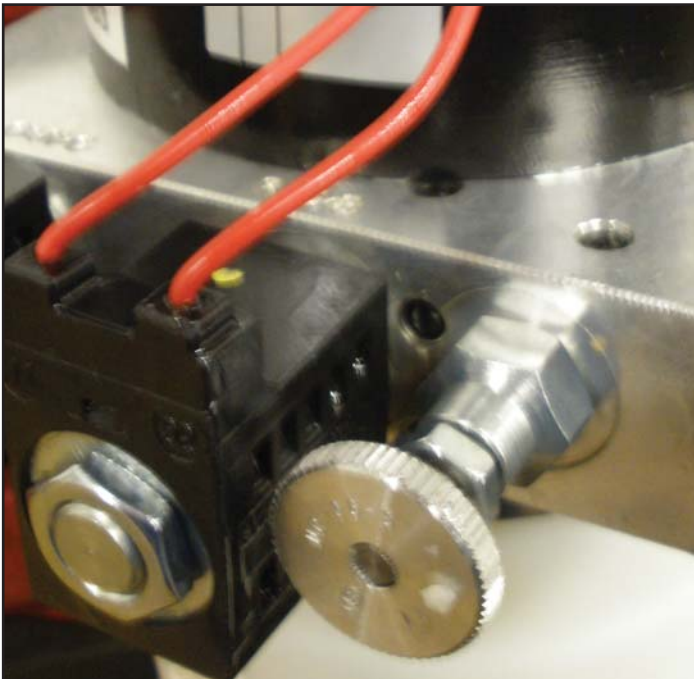

E-72 Lower Adjustment (left side of hydraulic unit); Loosen jam nut and turn knob clockwise to slow the drop of the plow and counter clockwise to speed the drop of the plow. Tighten jam nut.

N. Assemble adjustable stacking stop bolts to lift frame (12) using 5/8-11 x 3" bolts (61), lockwasher (24) and jamnuts (62). See below.

Note: Adjustment must be made after moldboard assembly is installed. Adjustment bolts (61) should make contact with the a-frame before any part of the A-Frame/ Sector or moldboard come in contact with the lift arm and, or hydraulic unit while raising the snowplow or stacking snow. Moldboard should be checked in all positions.

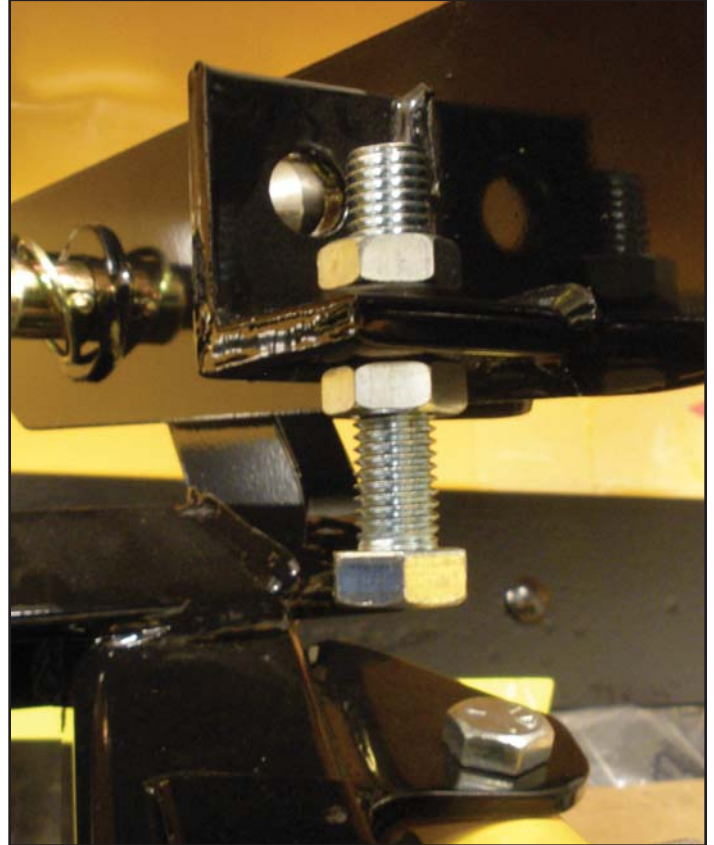

Mount Plow To Vehicle

For Mounting and Dis-mounting instructional video's please visit www.youtube.com/meyerproducts

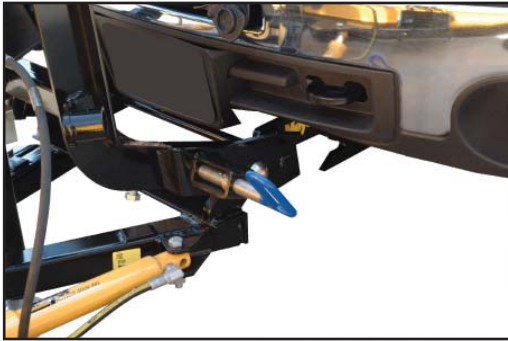

A. Pull vehicle into plow assembly and push plow assembly forward an inch or two.



B. Twist handles on both sides to engage spring loaded pins.

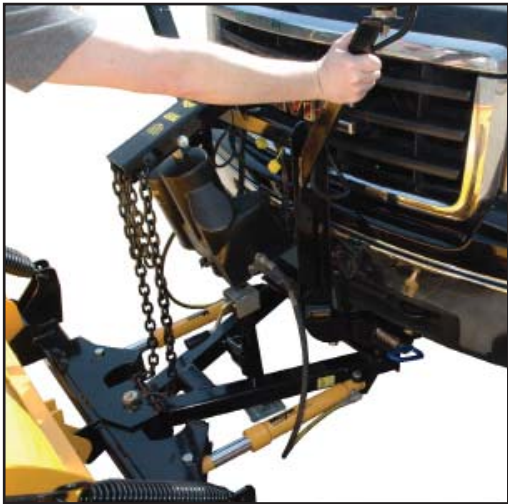

C. Push back on lift frame until both pins spring thru mount on vehicle.



E. Remove crankstand from a-frame.



F. Attach crankstand to lift frame.



G. Remove weather cover on male end and connect one piece electrical plug. The spring loaded cover will lock one piece plug.

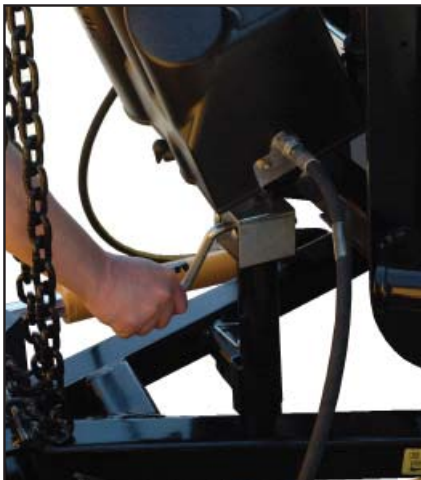

D. Adjust crankstand until it is no longer in contact with the ground.

Meyer Products assumes no responsibility for installations not made in accordance with these instructions.

Dis-Mount Plow From Vehicle

For Mounting and Dis-mounting instructional video's please visit www.youtube.com/meyerproducts



A. Press down button until float light turns blue.



E. Adjust crankstand until crankstand comes into contact with the ground and then turn 1 to 2 revolutions.

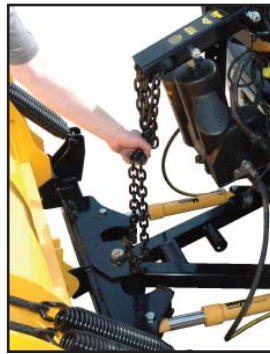

B. Push lift arm down until there is slack in the chain.

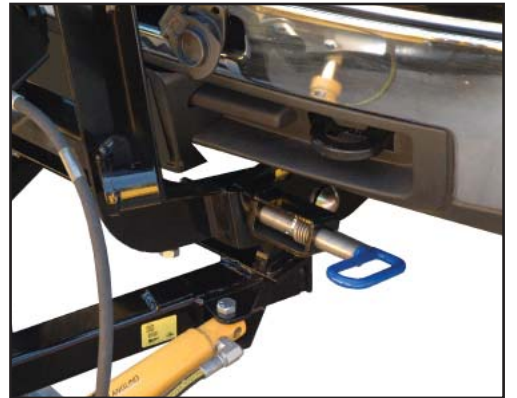
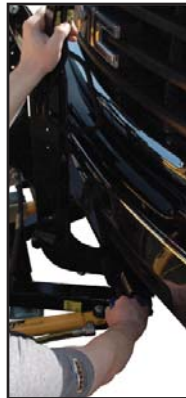

F. While slightly pushing the lift frame towards vehicle pull handles on either side to disengage pins then twist until the leg locks the pin in the open position.



C. Remove crankstand from lift frame.



G. Disconnect one piece electrical plug and install weather cover on male end.

D. Attach crankstand to a-frame



H. Back vehicle away from plow assembly.

Meyer Products assumes no responsibility for installations not made in accordance with these instructions.



PRE-DELIVERY INSPECTION

Vehicle Make: _____

Vehicle Model: _____

Vehicle Year: _____

Vehicle VIN#: _____

Vehicle FGAWR: _____

Installing Company: _____

Mounting Type:

EZ Plus

Plow Type:

7.5

Hydraulic Serial Number: _____

Moldboard Serial Number: _____

- All bolts torqued to specification
- Suspension interference
- Clevis height in inches _____
- Diode Installed
- Trip springs adjusted
- Lift Chain Adjusted
- Check for hydraulic fluid leaks
- Hydraulic fluid Level
- Dielectric grease applied to ALL electrical connection
- All wires/modules secured
- Plow Stops Adjusted (plow cannot bump hyd. unit)
- Controller Operation
- Controller Turns Off when vehicle shut off

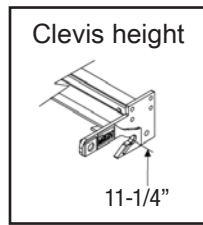

- Plow Operation Up
- Plow Operation Left
- Plow Operation Right
- Plow Operation Down
- Plow Drop Speed Adjusted
- Plow Light Blinker Left & Right Operation
- Plow Light Low & High Beam Operation
- Plow Lights Adjusted
- Plow Mount/Dismount reviewed with Customer
- Plow Operation reviewed with Customer
- HFP (Hands Free Plowing) reviewed with Customer
- Warranty/Registration/Owners Manual reviewed with Customer

Comments:

Inspected By: _____ W.O.# _____ Date: _____

Customer Signature: _____

Serial Number Decal Locations

E-72 unit serial number is under the cover attached to the hydraulic unit.



Moldboard serial number is attached to the back of the moldboard.



Lot Pro LD Moldboard Accessories

PART NO.	DESCRIPTION	CUTTING EDGE KITS			DEFLECTOR KITS		
		Steel	Rubber	Urethane	Molded	Rubber	Poly
09275	LPLD 7.6 STEEL	08178*	08189	08119	12039	08109	12078
09278	LPPLD 7.6 POLY	08178*	08189	08119	12039	08109	12078*

*Included with moldboard

Controllers and Controller Accessories



22790X
Joy Stick



22690DC
Pistol Grip
(standard)



22695DC
Pistol Grip DLX



22154
Touch Pad
(need 07691 adapter)



22799
Joy Stick
Cradle Mount



22798
Pistol Grip
Cradle Mount



22815
45-Degree
Cradle Adapter



22801 (10")
22844 (20")
Floor Mount

Mounting Accessories

16529
Meyer
Winch Cradle



08300 Brush Guard



Optional Light Guards
16536 ('99-07 Ford)
16537 ('99 + Chevy)
16539 ('99 + Dodge)