



PARTS & INSTALLATION INSTRUCTIONS

E-58H ELECTRO- LIFT®

with ELECTRO-TOUCH and 1-1/2" x 10" P.A. Rams

Parts List

Item	Part No.	Qty.	Description
	15988	1	Lift and P.A. Ass'y. (Complete) 12 volt
1	15995	1	• Lift Ass'y. (Unit only) 12 volt
2	15370	1	• Starter Solenoid - 12 volt
3	07620	2	• Ram L.H. & R.H. with Hose & Fittings
	07968	1	•• Ram (1-1/2" x 10")
4	22461	1	•• Hose Ass'y. SAE 1/4 x 38" Lg. M-6 Facesal
5	22460	1	•• SAE 6 x 90 Degree Elbow
	07290	1	• Harness Plug Assy.
6	22604	1	•• Female Socket (Hydraulic side)
7	22610	1	•• Male Plug (Vehicle Side)
8	22263	1	•• Weather Cover (Hydraulic side)
9	22279	1	•• Weather cover (Vehicle Side)
10	05024	1	• Power Cable - 36"
11	08473	1	• Relief Valve Kit - Reservoir
	15765	1	• Hardware Bag
	07273	1	•• Tap Connector
12	15673	1	•• Membrane Switch Bracket
13	15675	1	•• Clamp Plate
14	15676	1	•• Backup Plate
15	20312	2	•• Locknut 1/4 - 20
16	20863	2	•• Machine Screw 1/4 - 20 x 1" RND. HD.
17	21398	2	•• S. Tapping Screw 1/4 - 14 x 3/4"
18	21832	2	•• Bushing - Split
	21953	1	•• Decal - Danger (Mount on Dashboard)
	NOT USED	1	•• Washer 5/16 Int/Ext Tooth
	NOT USED	1	•• Bolt 5/16-18 x 1/2" Gr.2
19	22154	1	• Membrane Switch
	08364	1	• Hardware Bag (P.A. Rams)
20	20146	4	•• Bolt H 5/8 - 11 x 3 1/4" Gr. 5
21	20309	4	•• Locknut 5/8 - 11
*	08642	1	Kit Bracket (Floor Mount) *Optional
22	15677	1	• Bracket Floor
23	21398	4	• Hex Head Self Tapping Screw 1/4-14 x 3/4"
24	20325	4	• Lockwasher 1/4"
*	08206	1	Complete Coupler Kit *Optional
25	22442	1	• Male P.A. Block Coupler
26	22443	1	• Female Hose Coupler
27	22444	1	• Male Hose Coupler
28	22445	1	• Female P.A. Block Coupler

Parts indented are included in the carton, bag or assembly under which they are indented.

Meyer Products LLC reserves the right, under its continuing product improvement program, to change construction or design details, specifications and prices without notice or without incurring any obligation.

Meyer Products LLC
18513 Euclid Ave. • Cleveland, Ohio 44112-1084
Phone 486-1313 (Area Code 216)
www.meyerproducts.com • email info@meyerproducts.com

Meyer Products LLC
6 Angell Lane • Damariscotta, ME 04543-4507
Phone 563-2227 (Area Code 207)
www.meyerproducts.com • email info@meyerproducts.com



GENERAL INFORMATION:

CAUTION: Always disconnect battery prior to installation.

Check contents against the parts list to determine all are correct and included. When ordering parts, furnish Part No., Name and Description, Type of Hydraulic Unit and Moldboard Size.

SAFETY PRECAUTIONS should be used when **Electro-Lift®** is in OPERATION and plow is in a RAISED position. LOWER plow to ground when vehicle is PARKED.

OVERHAUL and SERVICE INFORMATION is covered on separate instructions.

For **Electro-Lift®** Unit maintenance, refer to "Owner's Manual."

NOTES:

1. Connect ground cable to negative side of battery for a solid connection to ground.
2. Caution: Route all cables away from moving engine parts, Manifolds, and sharp sheet metal.
3. For weather protection, tape all electrical connections at front of vehicle.
4. The vehicle must be equipped with a "Heavy Duty Battery" (70 Amp. Hr. Min.) 550 C.C.A. and "Alternator" (60 amp. Min.) to obtain maximum performance.
5. Follow these instructions explicitly. Warranty does not apply to a Meyer product which has been negligently or improperly assembled or installed.

INSTALLATION INSTRUCTIONS

- Remove shipping plug from filler hole and install Relief Valve Kit (11). Tighten to 100-125 in. lbs.
- Install the Female socket (6) of the Harness Plug assembly. Attach power cables to the Hydraulic Lift Unit (1). Attach the red (+) cable to the motor stud marked (A2). Attach the black (-) cable to the motor stud marked (D1). Connect the red, black and green wires from female socket (6) and connect to solenoids on the Power Angling Block. See Figure 2.

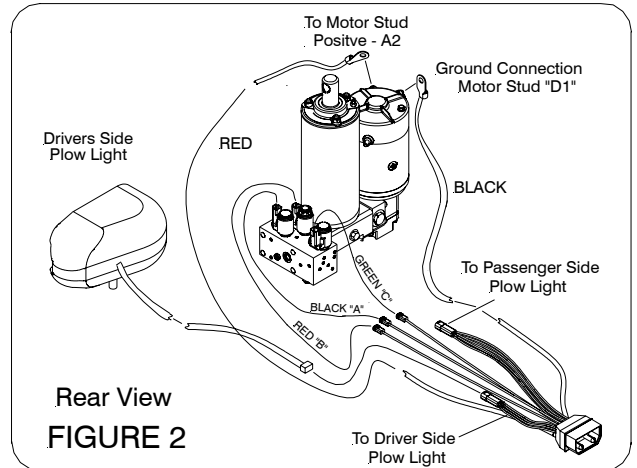

Figure 2

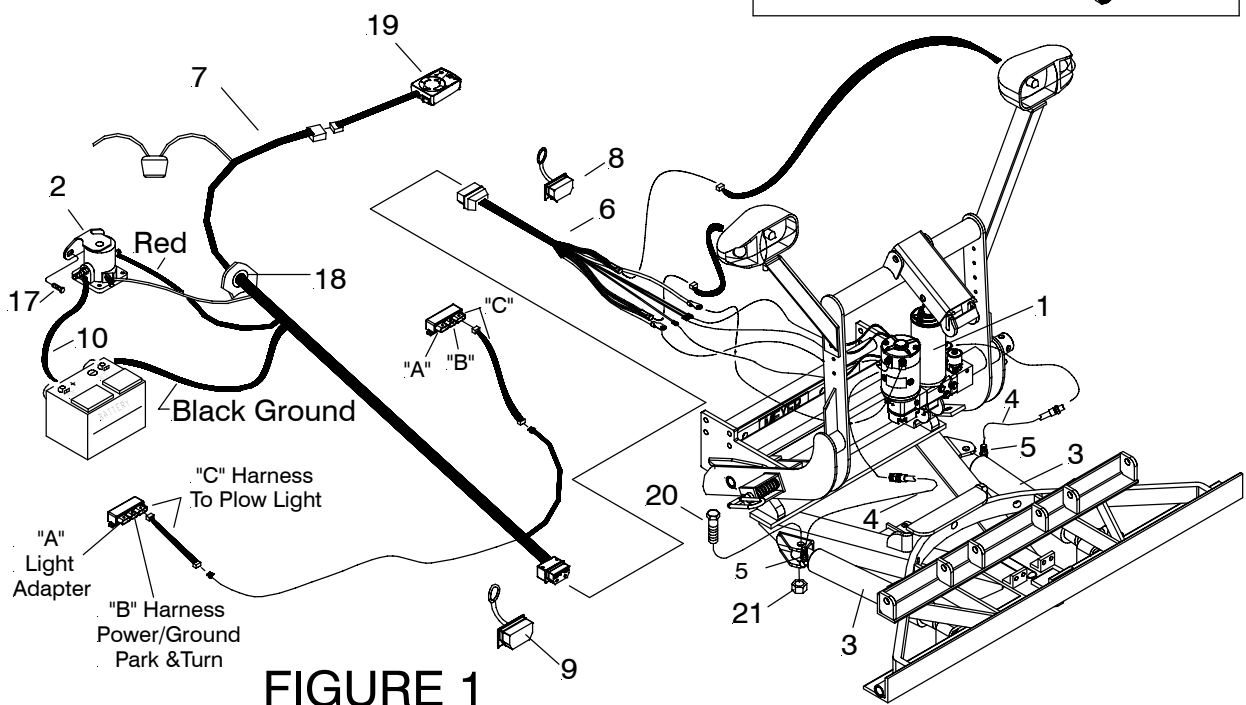
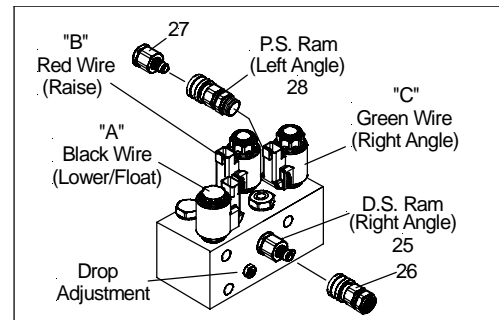

FIGURE 1

INSTALLATION INSTRUCTIONS CONT.

- C. Install E-58H Lift Assembly (1) to Lift Frame (using bolts supplied in the mounting carton), with the Electric Motor toward the right hand side (Passenger side); attach the lift ram to the Lift Arm. **When installing on E-Z Mount Classic, reference SB 208.**

WARNING:

Lift arm extends beyond bumper of vehicle. To minimize damage from a front-end collision, lift arm should be removed from vehicle when snow plow is not in use.

- D. Install Male Plug (7) through the vehicle grill.
- E. Choose a convenient location for the control switch. If the desired location is the dashboard, install Bracket (12) by drilling 2 holes in the dashboard and secure using Round Head Machine Screws (16) and Locknuts (15). Install Backup Plate (14) behind dash for added stiffness. See Figure 3. Also apply Danger Decal to dashboard.

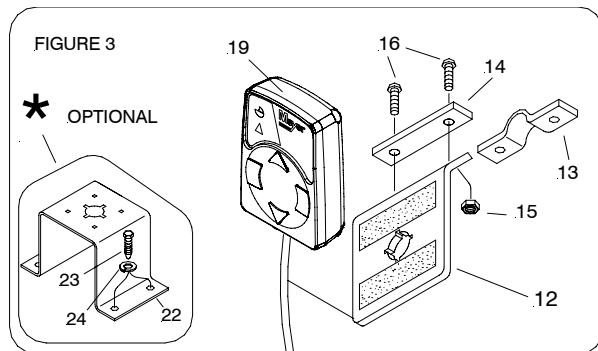

Figure 3

- F. To mount control to shift lever, use Bracket (12), Clamp Plate (13), Round Head Machine Screws (16) and locknuts (15). See Figure 3.
- G. The light switch, bracket and sheet metal screws (found in the light carton) can also be located wherever desired.
- H. Use Bushing (18) where Harness (7) is routed through firewall and radiator support panel. Requires 7/8" diameter hole. Be certain to route all wiring around hot or moving engine parts, and any sharp sheet metal. Protection must be provided to guard against wire damage at these points. All excess or loose wire must be neatly secured using wire ties. Fused lead from Wiring Harness (7) must be attached to terminal in fuse panel that is activated only when the ignition key is "on."
- I. Install Starter Solenoid (2) to metal surface in engine compartment using Screws (17). (Solenoid must be grounded to operate). Attach Red Power Cable (7) to a large terminal on Starter Solenoid (2). Attach Black Ground Cable (7) to negative (-) terminal of battery. Attach 36" Power Cable (10) to positive (+) terminal of battery and remaining large terminal on Starter Solenoid (2). Attach small white wire from harness (7) to small terminal on Starter Solenoid (2).

Note: All electrical connections should have both ends coated with a dielectric grease prior to final installation. This will ensure a good connection and help in preventing corrosion.

POWER ANGLING CYLINDERS:

Attach Meyer Power Angling Cylinders (3) to Sector and A-Frame using bolts (20) and locknuts (21).

Make certain Ram (3) on Driver's side connects to the Drivers side port on the P.A. Block (SEE FIGURE 1).

Optional Couplers Note: When installing plow system to a E-Z Mount Classic or Custom Mountings optional coupler kit 08206 must be purchased separately. These couplers will install between the P.A. Block and the hoses. When the Moldboard Assembly is removed from the vehicle, to prevent contamination to the Couplers and Hydraulic system, the L.H. and R.H. Power Angling Hoses must be reattached by plugging the couplers together.

Power Angling Cylinders furnished with the Electro-Lift® have been factory filled with the proper amount of fluid. If for any reason it is necessary to add fluid to Reservoir or to bleed the Power Angling Cylinders, proceed as follows:

- Remove Relief Valve (11) from Reservoir to add fluid during charging and bleeding.
- Temporarily loosen both hose connections at the R.H., L.H. Power Angling Cylinders. Base end of Cylinder must be higher than Rod end to enable trapped air to escape.
- Angle the Plow in both directions until fluid leaks out at both points in a steady flow.
- Retighten the hose connections.

NOTE:

Proper fluid level is 1-1/2" below filler hole. It must be checked with the lift arm fully retracted (down).

For snow plow light installation see separate instructions.

Reference Form 1-757 see Paragraph 7

Route Cables "C" (Yellow) from module to Male Plug (7). Connect both "C" Harness female ends to the male corresponding ends of the Male Plug (7). As per Figure 1.

Connect both male ends from the snow plow light to the female ends on the Female Socket (6). As per Figure 2.

Check snow plow light blinkers to make sure the wires have not been reversed.

Meyer Products LLC assumes no responsibility for installations not made in accordance with these instructions.