



## PARTS & INSTALLATION INSTRUCTIONS E-57 & E-57H ELECTRO-LIFT®

### PARTS LIST

STANDARD-UP THROUGH C-9		LONG STROKE-HM-9 & HM-10 ONLY		QTY.	DESCRIPTION	STANDARD-UP THROUGH C-9		LONG STROKE-HM-9 & HM-10 ONLY		QTY.	DESCRIPTION
ITEM	1-1/8" x 6" Stroke E-57	1-1/8" x 8" Stroke E-57H				ITEM	1-1/8" x 6" Stroke E-57	1-1/8" x 8" Stroke E-57H			
	<b>15865</b>	<b>15866</b>	<b>1</b>	<b>Lift Assy. (Unit only) 12 volt</b>	43*	15122	15122	3	O-Ring 1/4 I.D.		
	<b>15881</b>	<b>15885</b>	<b>1</b>	<b>Lift Assy. (Unit only) 24 volt</b>	44	21999	21999	1	<b>Drain Plug w/O-Ring - 9/16"</b>		
1	15869	15869	1	<b>Pump &amp; Motor Assy. (12 volt)</b>	45*	15127	15127	1	O-Ring 5/8 I.D.		
1b	15890	15890	1	<b>Pump &amp; Motor Assy. (24 volt)</b>	46*	21929	21929	3	Washer, Nyltite 5/16		
2a	15727	15727	1	• Motor - 12 Volt (2 Terminal)	47	20697	20697	3	Locknut 5/16 - 24		
2b	15891	15891	1	• Motor - 24 Volt (2 Terminal)	48	15972	15972	1	<b>"A" Solenoid Assembly</b>		
3	15889	15889	1	• Pump Assy.	49	15905	15905	1	•• "A" Coil, Black Wire (12V)		
4	15874	15874	1	•• Kit - Pump Relief Valve	50	15660	15660	1	•• "A" Cartridge Valve		
5	15870	15870	1	•• Relief Valve Assy.	51*	15431	15431	1	••• Seal Kit, "A" Valve		
6	15878	15878	1	•• Plug w/O-Ring	48b	15661	15661	1	<b>"A" Solenoid Assembly</b>		
7*	15875	15875	1	Seal Kit Relief Valve	49b	15659	15659	1	•• "A" Coil, Black Wire Plastic		
8	15877	15877	1	Pump Shaft Seal		15662	15662	1	•• "A" Coil, Black Wire (24V)		
9	22339	22339	3	Soc. Head 5/16-18 x 1-3/4"	50a	15660	15660	1	•• "A" Cartridge Valve		
10	15045	15204	1	Cylinder Tank	51b*	15431	15431	1	••• Seal Kit, "A" Valve		
11*	15131	15131	1	O-Ring 3-1/2 I.D.	52	15758	15758	1	<b>• Valve Assy. w/Coup. (12V)</b>		
12*	15163	15163	1	O-Ring 1-15/16 I.D.		15779	15779	1	<b>• Valve Assy. w/Coup. (24V)</b>		
13*	15198	15198	1	O-Ring 1-1/8 I.D.	53	22295	22295	1	• Forged 90 Degree Elbow		
14	15194	15194	1	<b>Cover &amp; Seal Assy.</b>	54	22294	22294	1	• Coupler, Female Half		
15*	05119	05119	1	• Wiper	55	22293	22293	1	• Coupler, Male Half		
16*	15131	15131	1	• O-Ring 3-1/2 I.D.	56	15639	15639	1	<b>• Kit-Pilot Check Valve</b>		
17	15199	15199	1	• Sleeve	57			1	•• Ball, Steel		
	08473	08473	1	<b>Pressure Relief Valve Kit</b>	58			1	•• Spring		
18	21805	21805	1	• Reducer Bushing 1/4 x 1/8	59			1	•• Plug		
19	21806	21806	1	• Pressure Relief Valve	60	15609	15609	1	• Piston		
20	15207	15205	1	Cylinder	61	15359	15359	1	<b>• Plug Valve Block</b>		
21	15209	15209	1	Washer (Grooves Down)	62*	15126	15126	1	•• O-ring 9/16 I.D.		
22	15335	15761	1	<b>Ram Assembly</b>	63	15697	15697	1	<b>• "B" Solenoid Assembly</b>		
23	15208	15206	1	• Ram	64	15382	15382	1	•• "B" Coil, Red Wire		
24	15158	15158	1	• Piston		15444	15444	1	•• "B" Coil, Red Wire (24V)		
25	15219	15219	1	• Piston Follower	65	15698	15698	1	•• "B" Cartridge Valve		
26	15760	15760	1	• Spacer	66*	15432	15432	1	•• Seal Kit-"B" Cartridge		
27*	15162	15162	1	• Packing Cup	67	15576	15576	1	<b>• Kit- "B" Check Valve</b>		
28*	15125	15125	1	• O-Ring 7/16 I.D.	68			1	•• Ball, 7/16		
29	20316	20316	1	• Locknut 1/2-13	69			1	•• Spring		
30	15573	15573	1	<b>Base &amp; Strainer Assy.</b>	70	15358	15358	1	<b>• "C" Solenoid Assembly</b>		
31	15326	15326	1	• Strainer	71	15430	15430	1	•• "C" Coil, Green Wire		
32	15641	15641	2	<b>• Filter Kit - 9/16"</b>		15445	15445	1	•• "C" Coil, Green Wire (24V)		
33	15619	15619	1	•• Filter	72	15381	15381	1	•• "C"-Cartridge Valve		
34	21999	21999	1	•• Plug w/O-Ring - 9/16"	73*	15433	15433	1	•• Seal Kit-"C" Cartridge		
35	15042	15203	3	Stud	74	15606	15606	1	<b>• Kit-Crossover Valve</b>		
36	15621	15621	1	Baffle	*	15610	15610	1	•• Seal Kit-Crossover Valve		
37	21980	21980	2	Retainer Ring					(includes items A,B,D,M)		
38	15574	15574	1	<b>Pump Check Valve Kit</b>	75	21826	21826	4	Soc. Head 5/16-18 x 1-1/2"		
39*	15124	15124	1	• O-Ring 3/8 I.D.							
40			1	• Seat							
41			1	• Ball, 9/32							
42			1	• Spring							

Parts indented are included in assembly under which they are indented.

**\* Parts included in Master Seal Kit Part No. 15888**

Basic Seal Kit Part No. 15254

Pump Relief Valve @ 2000 P.S.I. full flow. **Non Adjustable**

Set Crossover Relief Valve @ 3800 ± 400 P.S.I. @ 2-1/2 G.P.M.

Meyer Products Inc.  
18513 Euclid Ave. • Cleveland, Ohio 44112-1084  
Phone 486-1313 (Area Code 216)  
email•warranty@meyerproducts.com



Diamond Equipment  
6 Angell Lane • Damariscotta, ME 04543-9720  
Phone 563-2227 (Area Code 207)  
www.diamondplow.com • email info@diamondplow.com

# E-57 and E-57H Exploded View

## GENERAL INFORMATION

Before the Meyer Electro-Lift® unit is disassembled for repairs, make certain that all the maintenance procedures have been checked; refer to Owner's Manual. When the unit is to be overhauled, Master Seal Kit Part No. 15888 is required. This Kit contains all necessary Seals for rebuilding.

These instructions are intended as a guideline for overhaul of an E-57/E-57H Electro-Lift® unit.

When ordering parts, furnish Type of Unit, Part No., Name and Description.

More detailed information covering principles of Operation, Troubleshooting, Disassembly and Repair are found in Electro-Lift® Service Manual 1-562. This is available for a nominal fee from your Meyer Distributor.

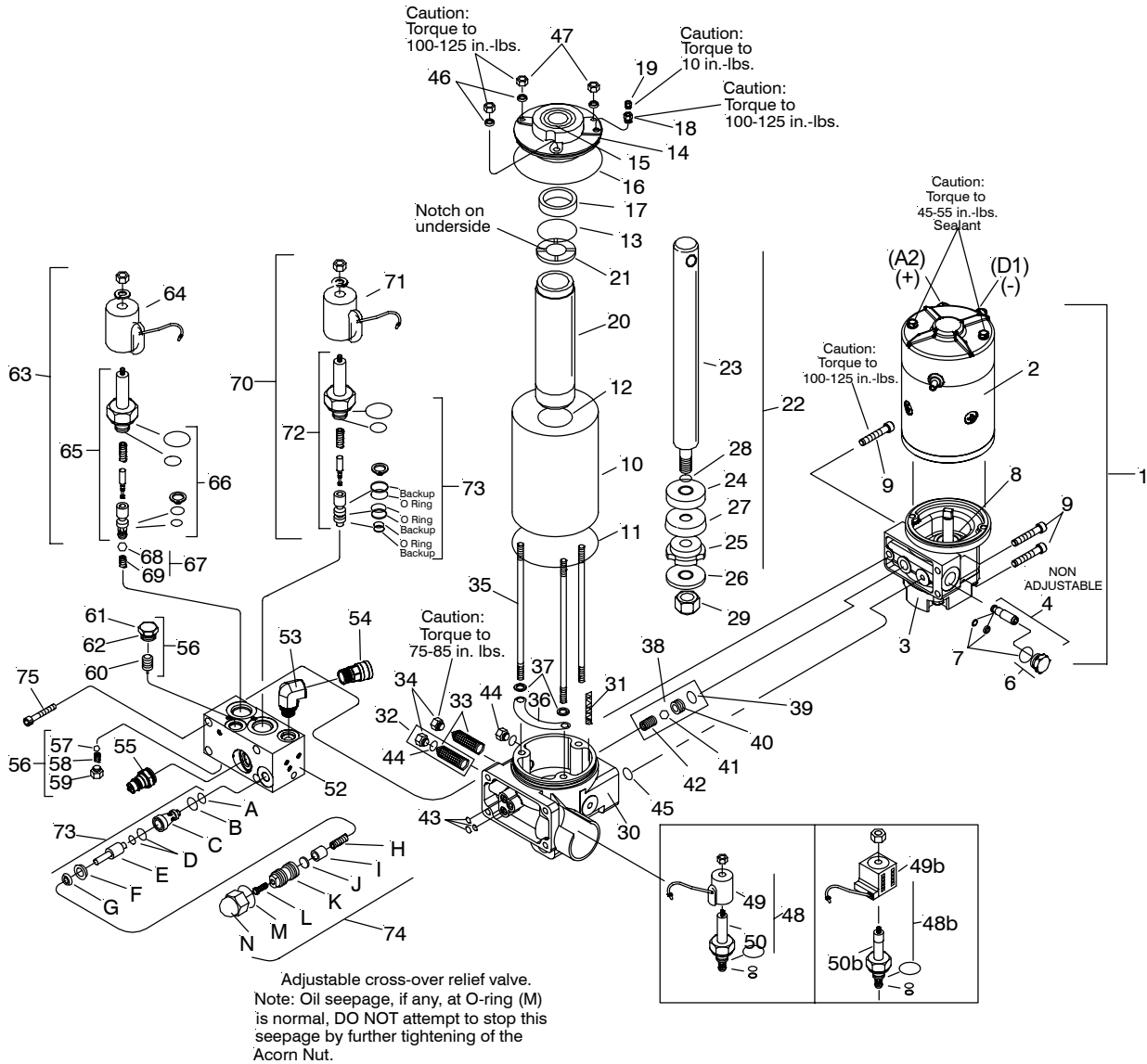

### NOTES:

1. \* Parts included in Master Seal Kit Part No. 15888
2. Basic Seal Kit Part No. 15254
3. Set Pump Relief Valve @ 2000 P.S.I. full flow. **Non Adjustable**
4. Set Crossover Relief Valve @ 3800 ± 400 P.S.I. @ 2-1/2 G.P.M. flow.

## DISASSEMBLY AND INSPECTION OF UNIT

### NOTE: DO NOT REUSE OLD O-RINGS.

Drain fluid from the unit by removing Pressure Relief Valve (19) or Drain Plug (44). Clamp Sump Base (30) firmly into vise.

1. To disassemble COVER ASSEMBLY, TANK, RAM & CYLINDER PARTS, remove three Locknuts (47).
2. To disassemble MOTOR from PUMP, loosen Motor mounting bolts, but DO NOT REMOVE bolts from motor housing.

**Note:** Motor end plate to be held in place. Temporarily install two 1/4-20 nuts on the motor mounting bolts to keep motor intact. Remove nuts when reinstalling Motor to pump.

3. To disassemble Pump from Base, remove three Soc. Hd. Screws (9).
4. To disassemble VALVE BLOCK from BASE, remove Soc. Hd. Screws (75).

### SUBASSEMBLIES - INSPECTION

#### 1. COVER ASSEMBLY, TANK, RAM & CYLINDER PARTS:

- a) Check Cover (14), and Base (30) castings for cracks and damage.
- b) Replace Wiper Seal (15) pressed in Cover (14).
- c) Inspect Sleeve (17), Piston (24), the Piston Follower (25), Spacer (26) for excessive wear. Replace Packing Cup (27). Inspect Cylinder (20) for scoring and pitting in bore.
- d) Inspect Ram (23) for nicks and rust.

#### 2. MOTOR - Two Terminal (2)

**Note:** Complete Motor Assemblies are only available from Meyer Products. The only service parts available are a Brush Kit 15854.

#### 3. PUMP (3)

**DO NOT at any time disassemble this Pump. This will void the warranty.**

- a) A damaged pump drive Shaft Seal (8) may be removed by careful extraction with a pointed tool. Dip new Seal in oil and with lip down, press into Pump Housing flush to 1/32 inch below face of boss.

#### 4. BASE (30)

- a) Remove and clean Solenoid (48) and inspect for external damage.
- b) Test Coil (49) for electrical continuity. Nominal Coil resistance is 9.6 ohms. Replace O-rings from Seal Kit Part No. 15431 contained in Seal Kit No. 15888.

- c) To reassemble, carefully guide the Coil (49) over the Valve Cartridge (50) assembled nut. Note: Use the original External Brass Nut on "A" Solenoid with 3/8" valve stem.
- d) Remove (32) and clean the Filter Screen (33) using kerosene and blow out with air. Replace O-rings (34) from Seal Kit No.15888.

#### 5. VALVE BLOCK (52)

- a) Remove items (63), (68) & (69). Clean "B" Cartridge (65) and inspect for damage. Disassemble Cartridge Valve (65) and replace O-rings from Seal Kit No. 15432 contained in Seal Kit No. 15888.
- b) Remove and clean "C" Solenoid (70) and inspect for damage. Disassemble Cartridge Valve (72) and replace O-rings and nylon back-up rings from Seal Kit No. 15433 contained in Seal Kit No. 15888. Be certain O-rings and spacers are oriented properly.
- c) Test both Coils (64 & 71) for electrical continuity. Nominal Coil resistance is 3.7 ohms.
- d) Remove Plug (61) and Piston Assembly (60) and inspect the Piston for scratches. Replace O-ring (62) from Seal Kit No. 15888.
- e) Remove Pilot Check Valve Parts (56) and inspect all parts for damage.
- f) Remove all parts of Item (74) and inspect for damage. Replace O-rings from Seal Kit No. 15888. Set adjustable crossover to 3800 P.S.I.  $\pm$  400 P.S.I.
- g) With parts removed from Valve Block, clean and blow out with air to remove any foreign particles in Block.

#### 6. UNIT REASSEMBLY

- a) Before reassembling, make certain all components and sub-assemblies are clean and free from all dirt and other foreign material. Coat all bolt threads with a anti-sieze lubricant prior to reassembly.
- b) When replacing parts, install (57), (58) & (59) before installing Piston (60) and Plug (61).
- c) Motor mounting bolts must be sealed with Permatex or an all weather type sealant.
- d) **USE NEW SEALS AND M-1 FLUID WHEN REASSEMBLING THE UNIT.**
- d) Proper fluid level is 1-1/2" below filler hole. It must be checked with Lift Ram fully retracted.