

MEYER SNOW PLOW LIGHTS

PARTS LIST

ITEM	PART NO.	QTY.	DESCRIPTION
1	07941	1	SNOW PLOW LIGHT CARTON
2	07942	1	• Snow Plow Light Pass. Side
3	07943	1	• Snow Plow Light Driver's Side
	07952	1	• Vehicle Wire Harness
4	07958	1	• Parts Bag
*5		1	• • Flasher w/Bracket (Tung-Sol #552 flasher or equal)
*6		2	• • Adapter Ferrule
*7		2	• • Lockwasher 1/2"
8	08553- (Kit of three)	2	• • Locknut 1/2" - 20"
9	08550	3	• • T-Tap Terminal - (3M #952K)
10	08550	1	• • Toggle Switch w/Hardware
11	15658	1	• • Extension Handle - Blue
12		1	• • Rubber Grommet (to fit 7/8" ϕ hole)
		3	• • Safety Pad
13	07944	1	Light Housing - Pass. Side
14	07945	1	Light Housing - Driver's Side
15	07946	1	Front Plate w/Screws (Pass. & Driver's Side)
16	07951	1	Light Harness
17	08549	1	Lens Kit - w/Gasket and Screws
18	08551	1	Bulb Mounting Kit
		4	• Bulb Pad Seat
		4	• Bulb Pad

Replacement Bulbs are to be purchased locally.

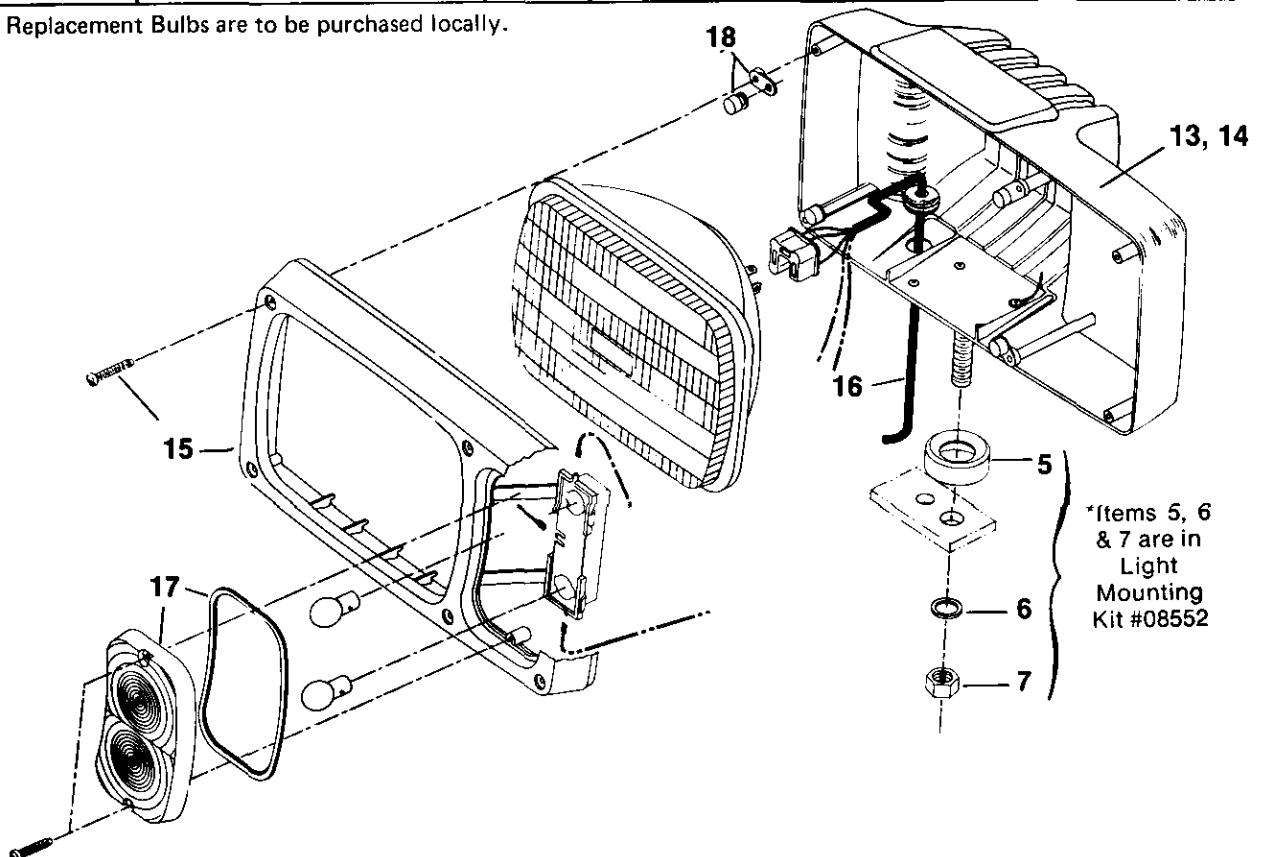

Meyer Products, Inc., reserves the right, under its continuing product improvement program, to change construction or design details, specifications and prices without notice or without incurring any obligation.

INSTALLATION INSTRUCTIONS

As packaged, the wiring harness (3) in the #07941 Light Kit is wired to work correctly with two headlamp systems of either the round or rectangular variety. (Fig. 1) If these lights are to be installed on a vehicle with four rectangular lights, follow the instructions given in Figure 2 for altering the harness (except Dodge D-50 & Mitsubishi vehicles with 4 lamps. See #4). On certain older or heavy trucks, a four lamp round system may be found. Follow the directions in Figure 3 to modify the harness for this application.

Once the harness (3) has been modified for its intended application, the installation may proceed as follows:

1. Locate the switch (9) in a convenient location, using the bracket supplied with the Electro-Touch Unit, or mount directly in the dash. Plug in wires from harness (3) as shown according to vehicle light type. Route harness (3) through 7/8" ϕ hole in firewall using grommet (11).
2. Unplug the vehicle light harness from the backs of the truck's headlamps. Plug the snow plow light harness (3)

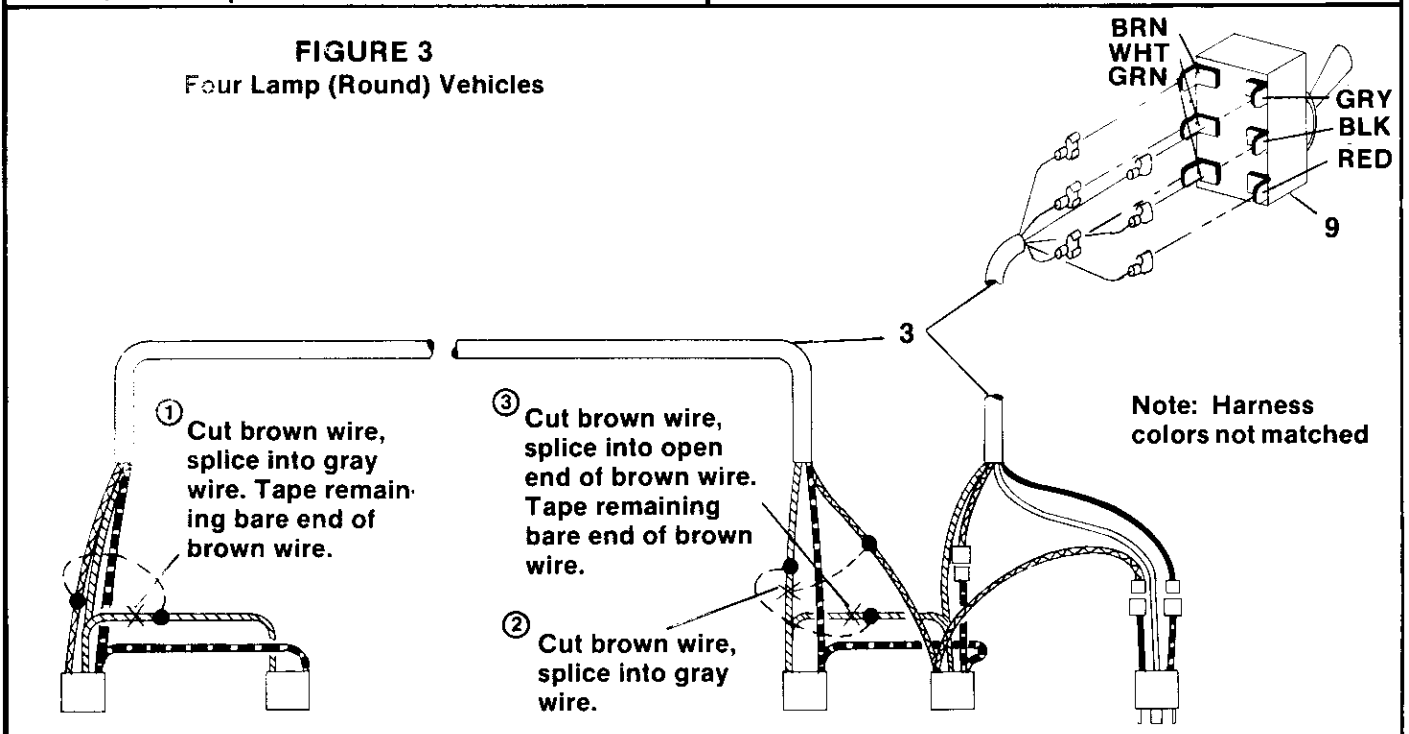
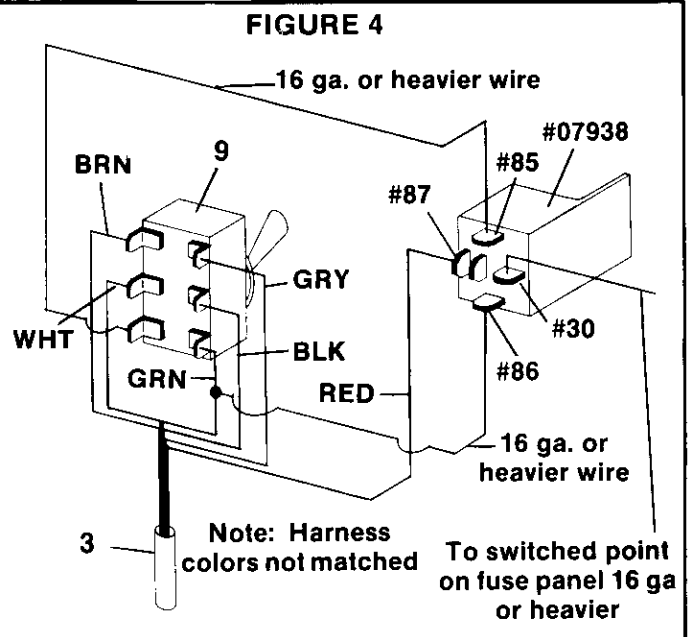
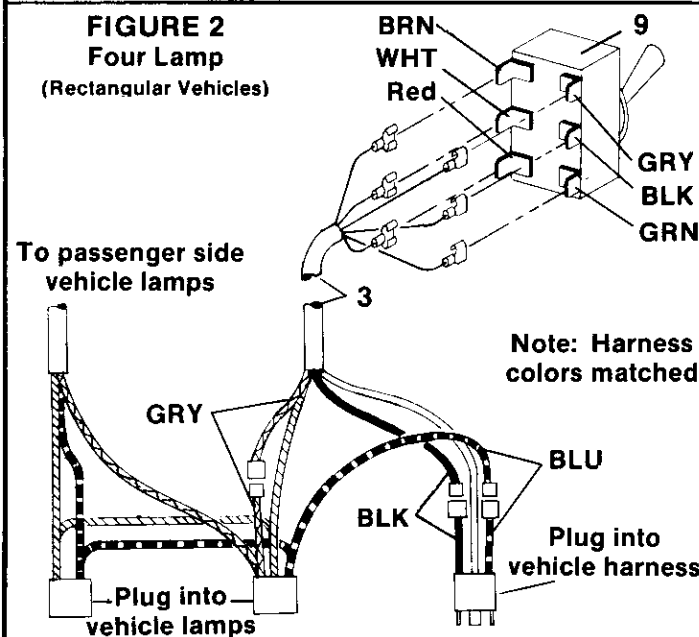
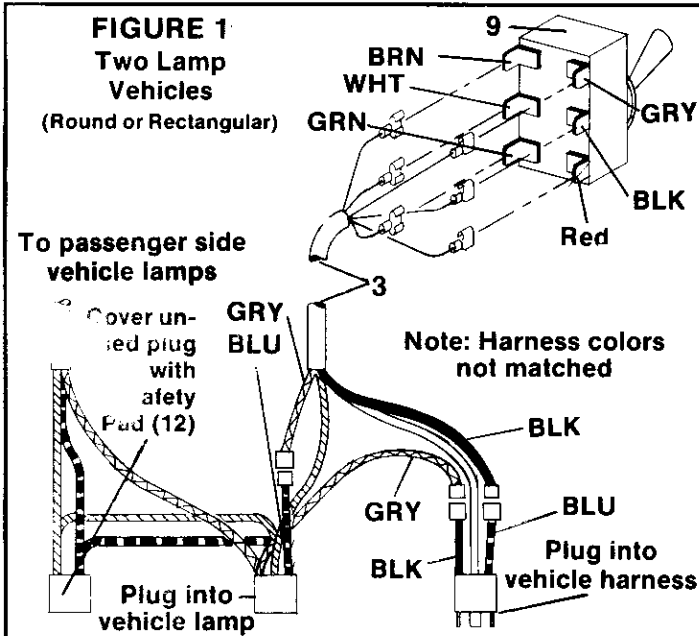

into the vehicle's light harness on the driver's side of the truck. (See Figure 5) Plug the snow plow light harness onto the vehicle's headlamps. Be certain the harness (3) is secured away from hot areas of the radiator, or moving or sharp objects as it crosses over to the passenger side of the truck. Use the insulating pads (12) to cover the vehicle's Light Plugs which are no longer used. On two headlamp vehicles, also use insulating pads (12) to protect the two unused plugs on the snow plow light harness (3).

3. Mount the headlight assemblies (1 & 2) on the light brackets being certain they do not interfere with opening or closing of vehicle hood. After they are connected to the snow plow light harness (3) (See Figure 5), it will be necessary to aim the light assemblies (1 & 2) so they comply with Federal Motor Vehicle Safety Standard 108. Tape all connections between headlight assembly (1 & 2) and light harness (3).

4. On all vehicles, except those listed below, attach the white wire from each headlight assembly (1 & 2) to a good chassis ground.

On the following vehicles, the eyelet on the end of the white wire from each headlight assembly (1 & 2) will be removed and a "T" connection made to the proper vehicle wire as listed below. These wires will be found

behind the right and left headlamps in the engine compartment.

1981 & Later Nissan (Datsun) 4x4 Pickup

	<u>Driver's Side</u>	<u>Passenger Side</u>
Connect white wire to:	Red/Blue Stripe	Red/Black Stripe

1979 & Later Toyota 4x4 Pickup

	<u>Driver's Side</u>	<u>Passenger Side</u>
Connect white wire to:	Red/White Stripe	Red/Black Stripe

5. On 1983 & Later Dodge D-50 and Mitsubishi 4x4 Pickups (those with four rectangular headlights) the white wires from the headlight assemblies (1 & 2) are grounded to the chassis. The light harness connections are then modified using relay #07938 (packaged in mounting carton) as shown in Figure 4. The harness (3) is used as received with connections **not** matched.

6. Using a test light, locate the turn signal and park light wires and connect using T-tap terminals (8) as shown in Figure 5.

7. Remove vehicle flasher unit and install heavy duty flasher (4).

8. Check for proper high-low beam operation of both vehicle and snow plow lights. Verify that only vehicle or snow plow lights are on at one time. Switch in up position for snow plow lights and down for vehicle lights.

FIGURE 5

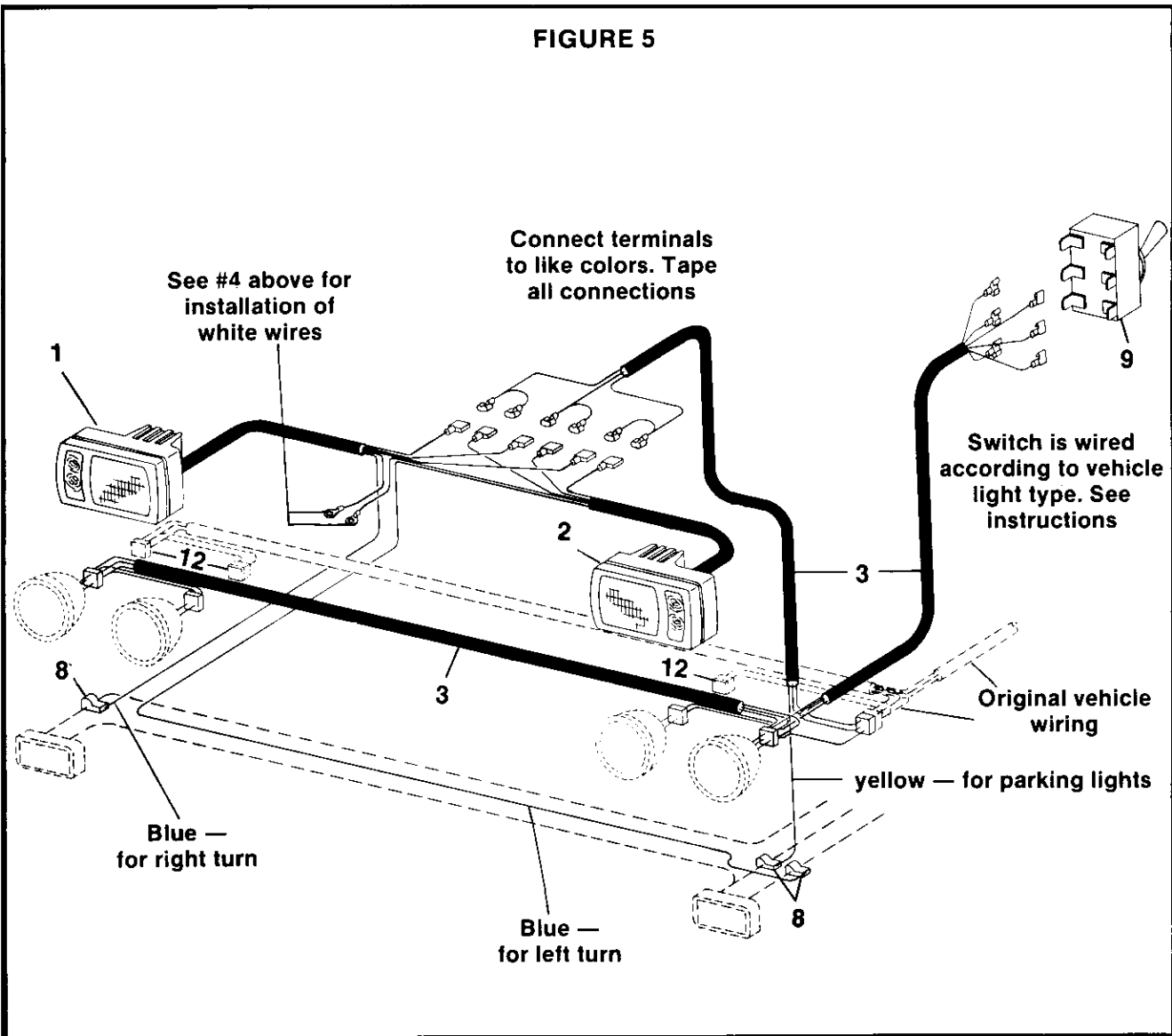

HARNES ADAPTION FOR NON-STANDARD HEADLIGHTS

Supplement to Form 1-609R

On some 1986 and newer vehicles containing specialty headlights the vehicle's headlamp plugs may be different than those on the #07952 harness. In these cases, it will not be possible to plug the #07952 harness into the vehicle's lighting system in the usual way. (With vehicles having normal terminals on the bulbs, ignore this form and follow standard installation procedures as shown on Form 1-609R). Use the following supplemental instructions for vehicles with non-standard bulbs.

Mount the switch and route wires through firewall as described in the instructions, Form 1-609R, and then proceed as follows:

- A. On the snow plow light harness, locate the junction of the three legs. Remove the leg for the vehicle headlights by disconnecting the black, white, gray and brown wires at the in-line connectors and set aside this leg. It will not be used.
- B. In the vehicle engine compartment, probe and identify the high and low beam wires for the vehicle headlights. Cut these two wires and using plastic tap connectors, connect the four ends of these two wires to the #07952 snow plow light harness as shown in the drawing.

NOTE: Some vehicles have separate wires for Left and Right lights. In these cases, twist Left and Right High Beam wires together and Left and Right Low Beam wires together and treat them as single wires when attaching to snow plow light harness #07952.

Connect the wires of the snow plow light harness to the toggle switch as shown.

Tape over the connector ends of the black, white, gray and brown wires of the snow plow light harness to insulate them from grounding.

Proceed with Step (3) of the instructions.

