

MEYER ELECTRO-LITES PARTS & INSTALLATION INSTRUCTIONS

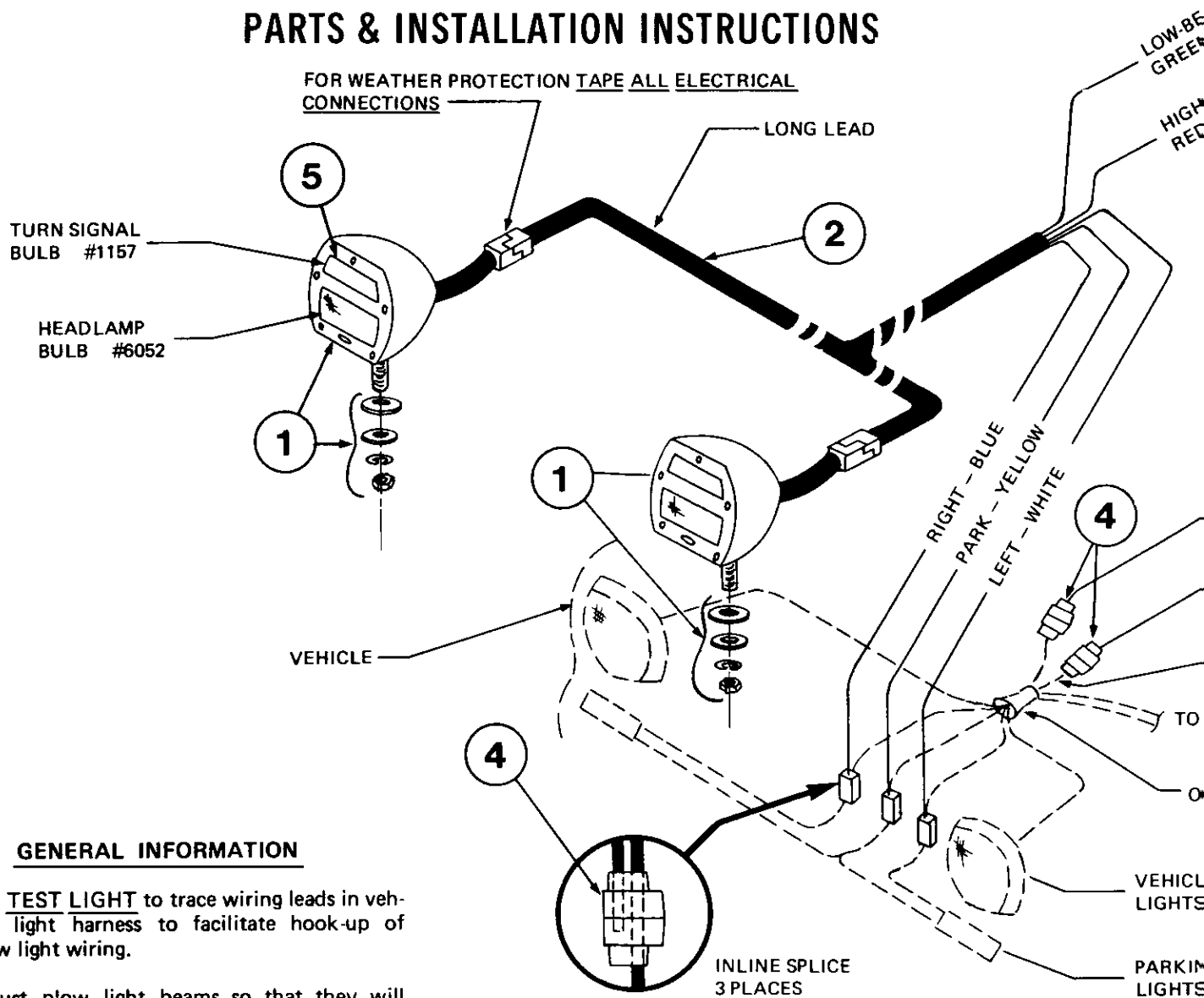

GENERAL INFORMATION

Use TEST LIGHT to trace wiring leads in vehicle light harness to facilitate hook-up of plow light wiring.

Adjust plow light beams so that they will illuminate the roadway for the same distance ahead, as compared to the original vehicle headlights.

IT IS ILLEGAL: to block the plow light beams with any portion of the plow.

IMPORTANT

INSTALLER OF THESE PLOW LIGHTS MUST CERTIFY THAT THE INSTALLATION CONFORMS TO THE FEDERAL MOTOR VEHICLE SAFETY STANDARD 108.

CHECK THE PARTS AGAINST THE PARTS LIST TO DETERMINE ALL ARE CORRECT AND INCLUDED.

ITEM	PART NO.	QTY.	DESCRIPTION
1	07855	1	CARTON-PLOW LIGHTS
2	07856	2	. Headlamp
3	07316	1	. Harness Ass'y.
4	07860	1	. Switch
	07859	1	. Parts Bag
	07273	7	. . Tap Connector
	07276	1	. . Flasher
5	07861	2	Not Included: Replacement Lens Kit

PART
UNDE
WHEM
AND

Meyer
withou

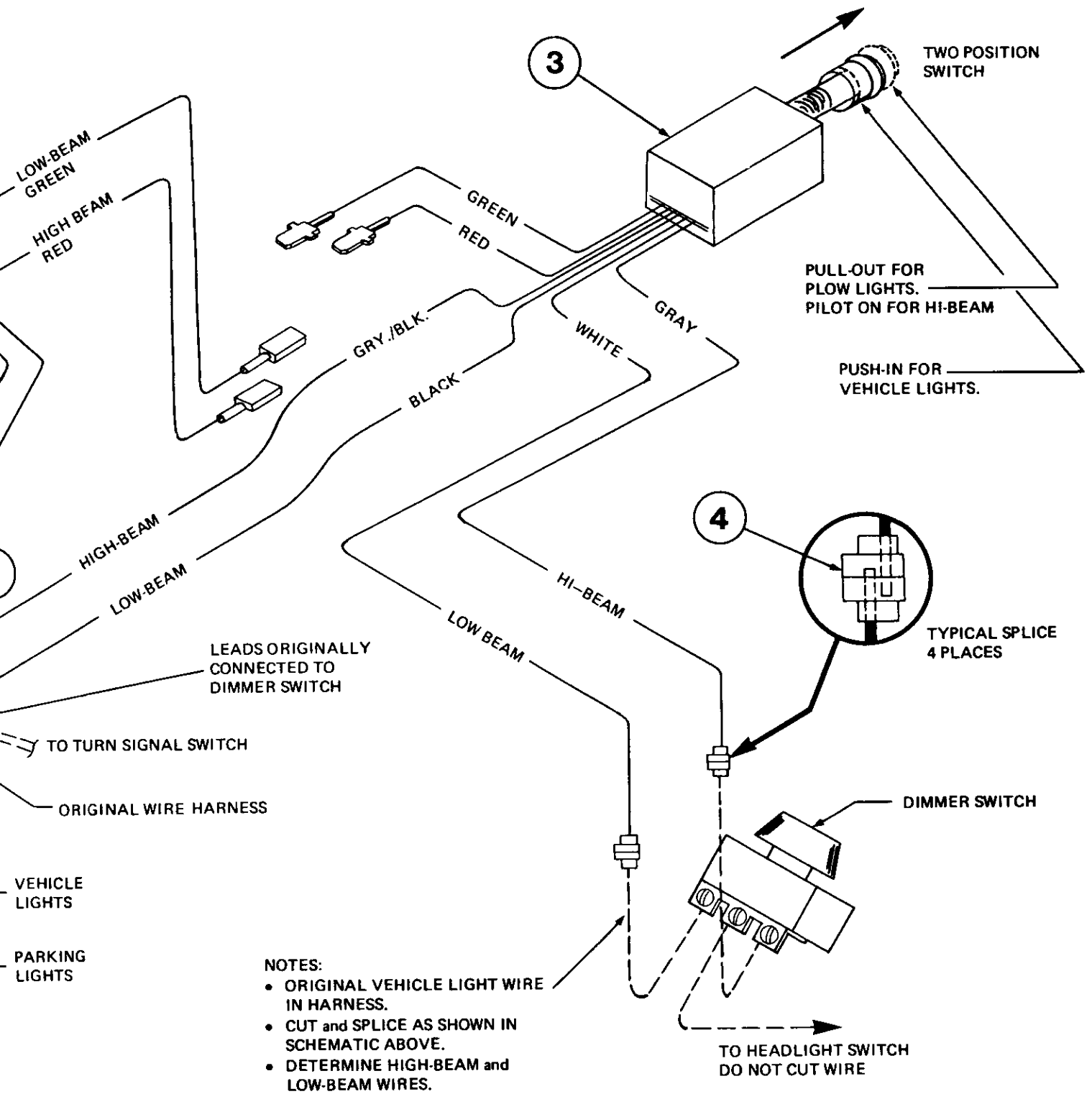

- NOTES:**
- ORIGINAL VEHICLE LIGHT WIRE IN HARNESS.
 - CUT and SPLICE AS SHOWN IN SCHEMATIC ABOVE.
 - DETERMINE HIGH-BEAM and LOW-BEAM WIRES.

PARTS INDENTED ARE INCLUDED IN THE ASSEMBLY UNDER WHICH THEY ARE INDENTED.
 WHEN ORDERING PARTS, FURNISH PART NO., NAME, AND DESCRIPTION

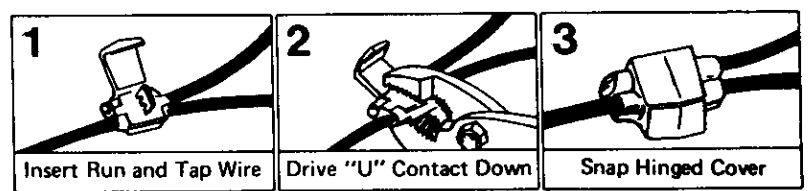

EASY STEPS FOR INSTALLING TAP CONNECTOR. DO NOT STRIP WIRES WHEN USING TAP CONNECTOR (ITEM #4).

Meyer Products, Inc., reserves the right, under its continuing product improvement program, to change construction or design details, specifications and prices without notice or without incurring any obligation.

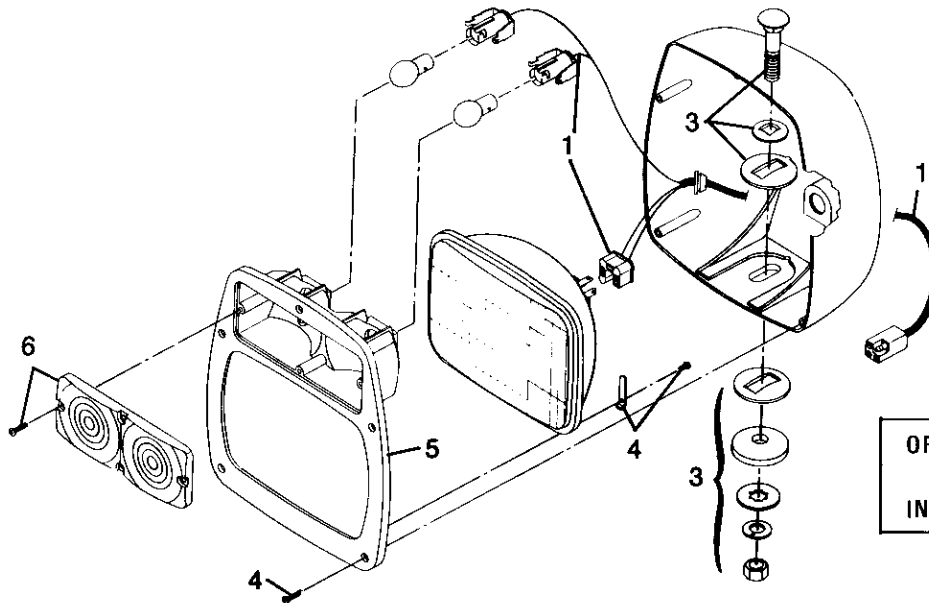

ITEM	PART NO.	QUANTITY	DESCRIPTION
1	07937	1	Headlamp Harness
2	07929	1	Housing
3	08504	1	Mounting Bolt Assembly
		1	• Carriage Bolt
		1	• Lower Spherical Support
		1	• Washer, 1/2
		1	• Housing Reinforcement
		1	• Upper Spherical Support
		1	• Nut, 1/2-20
		1	• Washer, Lock-Internal Tooth
		1	• Lockwasher, 1/2
4	08485	1	Hardware Bag, Front Plate
		4	• Sealed Beam Retainer
		4	• Screw, Self Tap 8-18 x 5/16
		5	• Screw, Self Tap 8-18 x 3/4
5	08484	1	Front Plate Kit
		5	• Screw, Self Tap 8-18 x 3/4
6	07861	1	Lens Kit
		4	• Screw, Self Tap 8-18 x 3/4
	07316	1	Harness Assembly
	07860	1	Switch
		1	• Switch Knob
	07859	1	Parts Bag
	07273	7	• Tap Connector
	07276	1	• Flasher

NOTE: Light Bulbs to be purchased locally.

Parts indented are included in the carton, bag or assembly under which they are indented.

Vehicle manufacturer specifications must be adhered to for the installation of this equipment.

Meyer Products, Inc., reserves the right, under its continuing product improvement program, to change construction or design details, specifications and prices without notice or without incurring any obligation.